

Wear Plate

EUROPEAN STANDARD

VDI (SP2)
VDI (SIN)

(SP2)

(SIN)

● Form A

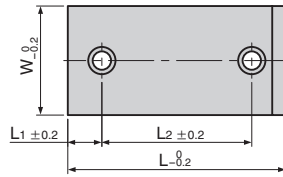
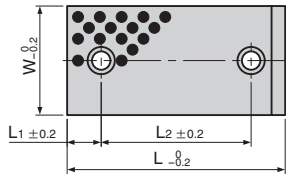

● Form B

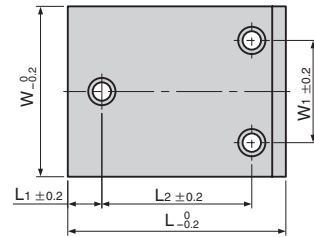
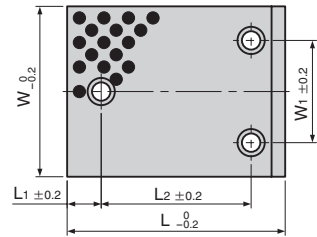

● Form C

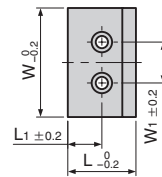
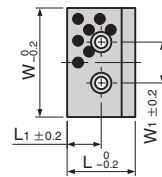

● Form D

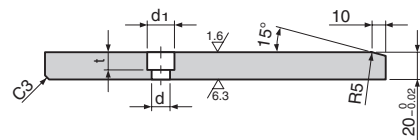
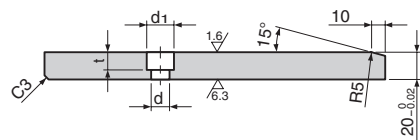
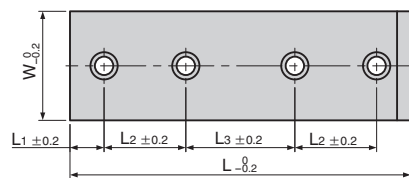
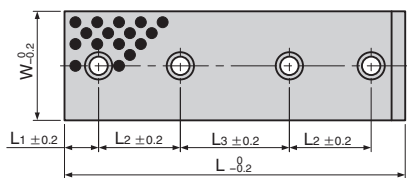

● Sliding Direction



VDI (SP2) (Material) SO#50SP2

VDI (SIN) (Material) SO#220

Hatched Area Sintered
Thickness 1.2mm or more
SS400 (base plate)

Catalog No.		W	L	L1	L2	L3	W1	Form	d	d1	t	Recommended mounting bolt
Bronze with Graphite "SP2" Type	Copper Powder Sintered "SIN" Type											
VDI-12-SP2	VDI-12-SIN		80		30				9	15	9	M8x25
VDI-13-SP2	VDI-13-SIN		100		50							
VDI-14-SP2	VDI-14-SIN		125		75	—	—	A				
VDI-15-SP2	VDI-15-SIN		160		110				13.5	20	13	M12x25
VDI-16-SP2	VDI-16-SIN		200		150							
VDI-111-SP2	VDI-111-SIN		250		60	80		D				
VDI-21-SP2	VDI-21-SIN		50	25	—		30	C	9	15	9	M8x25
VDI-22-SP2	VDI-22-SIN		80		30							
VDI-23-SP2	VDI-23-SIN		100		50							
VDI-24-SP2	VDI-24-SIN		125		75	—	—	A	13.5	20	13	M12x25
VDI-25-SP2	VDI-25-SIN		160		110							
VDI-26-SP2	VDI-26-SIN		200		150							
VDI-121-SP2	VDI-121-SIN		250		60	80		D				
VDI-31-SP2	VDI-31-SIN		50	25	—		50	C				
VDI-32-SP2	VDI-32-SIN		80	40								
VDI-33-SP2	VDI-33-SIN		100		50	—						
VDI-34-SP2	VDI-34-SIN		125		75			A	13.5	20	13	M12x25
VDI-35-SP2	VDI-35-SIN		160	25	110		—					
VDI-36-SP2	VDI-36-SIN		200		150							
VDI-150-SP2	VDI-150-SIN		250		60	80		D				
VDI-41-SP2	VDI-41-SIN		50	25	—			C				
VDI-42-SP2	VDI-42-SIN		80	40								
VDI-43-SP2	VDI-43-SIN		100		50	—	75					
VDI-44-SP2	VDI-44-SIN		125		75			B	13.5	20	13	M12x25
VDI-45-SP2	VDI-45-SIN		160	25	110							
VDI-46-SP2	VDI-46-SIN		200		150							
VDI-155-SP2	VDI-155-SIN		250		60	80	—	D				
VDI-51-SP2	VDI-51-SIN		50	25	—			C				
VDI-52-SP2	VDI-52-SIN		80	40								
VDI-53-SP2	VDI-53-SIN		100		50	—						
VDI-54-SP2	VDI-54-SIN		125		75		110	B	13.5	20	13	M12x25
VDI-55-SP2	VDI-55-SIN		160	25	110							
VDI-56-SP2	VDI-56-SIN		200		150							
VDI-160-SP2	VDI-160-SIN		250		60	80		D				



Catalog No.

VDI-25-SP2

Order



Refer to page 1323 for the steel type.