

Guide Post Set

OILLESS PLAIN TYPE

CAD
FILE



SGR
SGRL (Type for Dimension L)

With dowel pin hole
SGRN
SGRNL (Type for Dimension L)

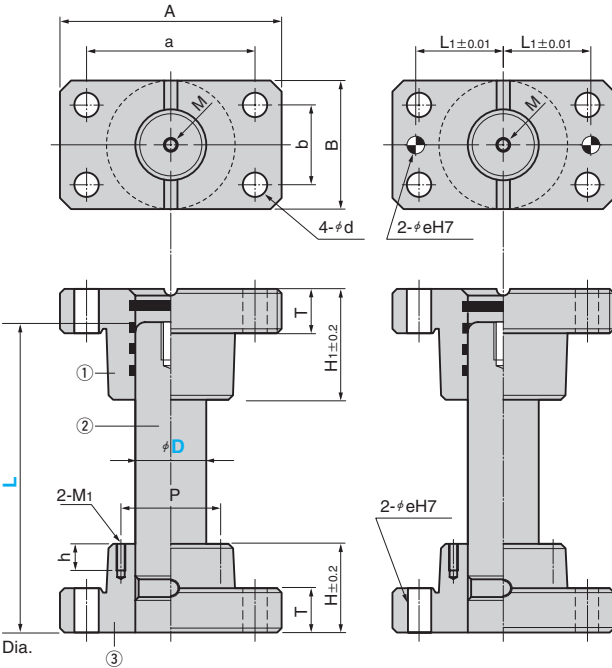

⚠ Tapped holes (2-M1) on Dia. $\phi 38$ or more.

Table of Components

No.	Description	Qty	Material and Remark	Catalog No.
①	Guide Bushing	1	FC250 with Graphite	SGRB, SGRBN
②	Guide Post	1	S45C Induction Hardened HRC55 or more	NGP
③	Guide Holder	1	FC250	GPH, GPHN
Accessories	Hexagon Socket Head Bolt	8	SCM435	
	Dowel Pin with Female Thread	4	SUJ2 Tolerance m6	

Accessories

D	Hexagon Socket Head Bolt	Dowel Pin
25	M8×35	$\phi 8 \times 30$
32	M10×40	
38	M10×45	$\phi 10 \times 40$
50	M12×50	
60	M16×60	$\phi 13 \times 50$
80	M20×75	$\phi 16 \times 60$

D Tolerance	A	a	B	b	T	H	P	M ₁	h	H ₁	d	M	L ₁	e	H7
25	+0.024 +0.015	84	66	48	30	20	-	-	-	45	9	-	33	8	
32		100	76	58	36					50	11	-	38		+0.015 0
38	+0.028 +0.017	130	100	75	44	25	50	60	M5	15	60		50	10	
50		155	125	90	60		65	72	M6		85	14	62.5		
60		190	150	120	80	30	75	92	M8	20	100	18	75	13	+0.018 0
80	+0.033 +0.020	230	180	150	110	35	100	116			130	22	95	16	

Catalog No.	D	L															
	25	80	90	100	110	120	130	140	150	160	170	180	200				
	32		90	100	110	120	130	140	150	160	170	180	200	220	250		
SGR	38			100	110	120	130	140	150	160	170	180	200	220	250	280	300
SGRN	50									160	170	180	200	220	250	280	300
	60											180	200	220	250	280	300
	80													250	280	300	350

Catalog No.	D	L
	25	70 to 200
	32	80 to 250
SGRL	38	80 to 300
SGRNL	50	120 to 350
	60	140 to 400
	80	200 to 450



Order

Catalog No.	D	L
SGRN	32	170
SGRL	60	320



Option

Refer to page 83 to 84 for option details.

Option Code	Specification
C	Dowel pin hole for location is drilled at the center of the guide post.
M	Tapped hole for the height block is drilled on the guide holder. (D=25, 32 only)
W	Tapped hole for the height block is drilled on the guide bushing.
RH	Guide holder is changed to the inverted mounting type.
RB	Guide bushing is changed to the inverted mounting type.
RHB	Both guide bushing and holder are changed to the inverted mounting type.
HK	Guide holder height is machined to the tolerance of ± 0.1 .
BK	Guide bushing height is machined to the tolerance of ± 0.1 .
HBK	Both guide holder and bushing heights are machined to the tolerance of ± 0.1 .
BM	Tapped hole for lifting bolt is drilled on the guide bushing. (D=25 to 50 only)
HM	Tapped hole for jack screw is drilled on the guide bushing. (D=25 to 50 only)



Order

SGRN 32 - 170 - RHB