



Guide Bushing

FOR EJECTOR AND STRIPPER PLATES



SOVM

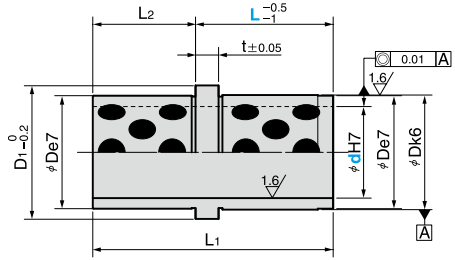

● Sliding Direction



Material : Bronze with Graphite (SO#50 SP2)

*Operation ambient temperature: 0 to 300°C

L1	L2	t	D	Tolerance		D1	d H7		Catalog No.	d	L
				e7	k6						
15	6	3	14	-0.032 -0.050	+0.012 +0.001	16	9	+0.015 0	SOVM	9	009
26	9						10	0		10	017
39	17		20			25	14	+0.018 0		14	017
							15			15	022
49	22	6	26	-0.040 -0.061	+0.015 +0.002	31	18			18	022
							20			20	027
63	27		30			35	22	+0.021 0		22	027
							24			24	036
73			42	-0.050 -0.075	+0.018 +0.002	47	30	+0.025 0		30	036
							32			32	046



Order

Catalog No.	d	-	L
SOVM	24	-	036