

Oilless Slide Guide

Copper Alloy
L-Shaped Type
SO#50SP2

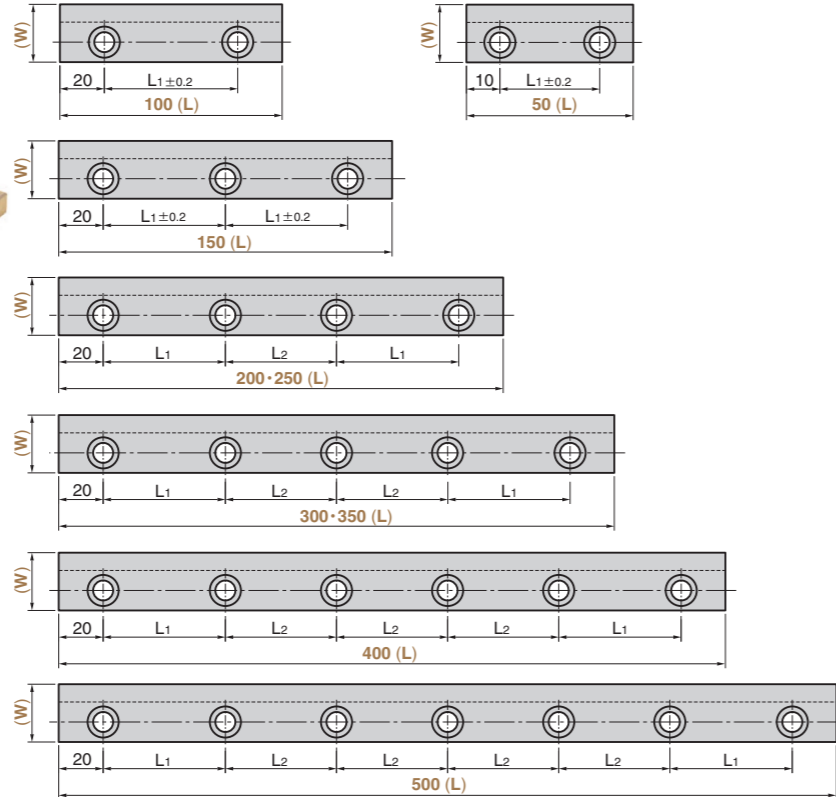

SOL

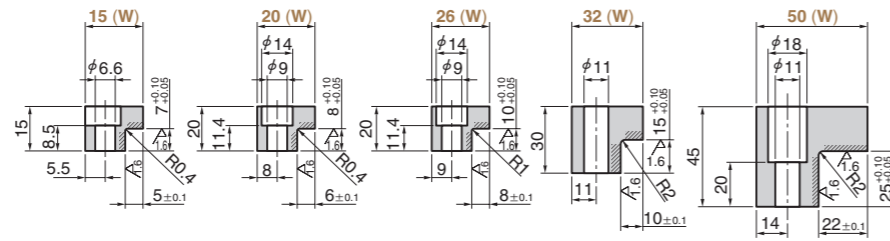

● Sliding Direction



Material Base Copper alloy (SO-2)
Hatched area solid lubricant (GR-1)

Operation Range

Lubricant Type	Lubricating Condition	Environment Condition	Max. Allowable Load P N/mm ²	Max. Allowable Sliding Speed V m/min	Max. Allowable PV value N/mm ² · m/min	Operation Range Temperature °C
GR-1	No lubrication	Atmosphere	100	15	150	-50 ~ +300
	Regular lubrication (Grease)			30	200	-50 ~ +150

⚠ When the product is used at high temperature (150°C or more), the embedding specification of solid lubricant is different. Please contact us for details.

Physical Properties

Specific Gravity	Hardness HB	Elongation %	Tensile Strength N/mm ²	Linear Expansion Coefficient × 10 ⁻⁵ /°C
7.9	210 or more	12 or more	755 or more	1.9

Bolt Position		Mounting Bolt		Catalog No.	W	L
L ₁	L ₂	Size	Quantity			
30	—	M6	2	SOL	15	50
60	—		3			100
55	—		4			150
55	50		4			200
30	—	M8	2	SOL	20	50
60	—		3			100
55	—		4			150
55	50		4			200
60	—	M10	2	SOL	26	100
55	—		3			150
55	50		4			200
75	70		6			400
60	—	M10	2	SOL	32	100
55	—		3			150
55	50		4			200
70	70		6			400
55	50	M10	4	SOL	50	200
70	70		4			250
65	65		5			300
80	75		5			350
80	75	M10	7	SOL	50	500
80	75		7			500



Order

Catalog No.

W — L

SOL

26 — 100

● Mounting hole shape W=15

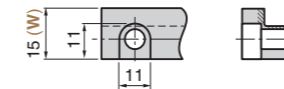

● Mounting hole shape W=32

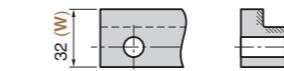

■ We are ready to accept requests or orders for special parts.