

Oilless Slide Plate

Cast Iron Type
Thickness 20 mm
SO#50F



SESF (FC Standard Type)



● W = 28 ~ 58 ● W = 75
*1 W = 28 L = 75
R2 (All around)

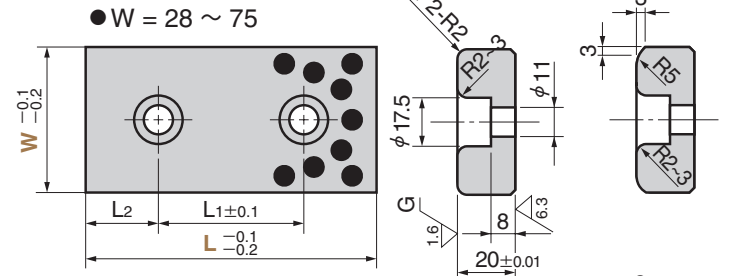

● W = 100 or more

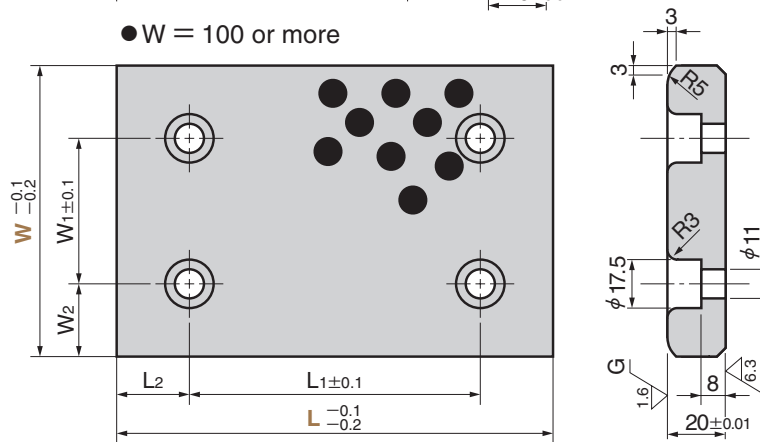

● Sliding Direction
W = 28 · 38
W = 48 or more

SESFT (FC 2-Hole Type)

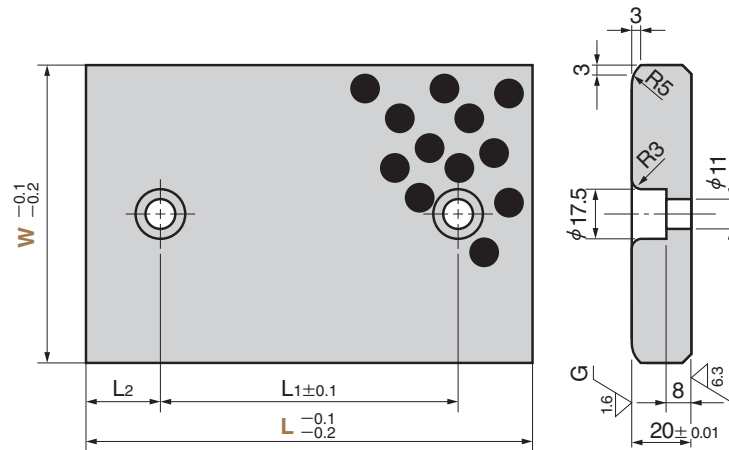

● Sliding Direction

Material Base FC250 or equivalent
Solid lubricant (GR-1)

Operation Range

Lubricant Type	Lubricating Condition	Environment Condition	Max. Allowable Load P N/mm ²	Max. Allowable Sliding Speed V m/min	Max. Allowable PV value N/mm ² · m/min	Operation Range Temperature °C
GR-1	No lubrication	Atmosphere	5	10	30	-50 ~ +300
	Regular lubrication (Grease)			15	50	-50 ~ +150

⚠ When the product is used at high temperature (150°C or more), the embedding specification of solid lubricant is different. Please contact us for details.

Physical Properties

Specific Gravity	Hardness HB	Elongation %	Tensile Strength N/mm ²	Linear Expansion Coefficient × 10 ⁻⁵ /°C
7.1 ~ 7.3	160 ~ 220	—	150 ~ 250	1.0

W ₁	W ₂	L ₁	L ₂	Catalog No.	W	L	
						SESF	SESFT
		45	15			75	
		50				100	
		75	25		28	125	
		100				150	
		150				200	
		45	15			75	
		50				100	
		75	25		38	125	
		100				150	
		150				200	
		45	15			75	
		50				100	
		75	25	SESF	48	125	
		100				150	
		150				200	
		45	15			75	
		50				100	
		75	25		58	125	
		100				150	
		25				75	
		50	25			100	
		75				125	
		100			75	150	
		150				200	
		100	50			300	
		50				100	100
		75				125	125
50	25	100	25		100	150	150
		150				200	200
		200				250	250
		75	50			300	—
		100		SESF		125	125
		150	25	SESFT	125	150	150
50	37.5	200				200	200
		250	50			250	250
		100				300	—
		150				150	150
100	25	200			150	200	200
		250	25			250	250
		150				300	300
150	25	200		SESF	200	200	—
		250				250	—
		300				300	—



Order

Catalog No.	W	—	L
SESF	48	—	75
SESFT	125	—	125