

AERIAL CAM UNIT

グレード	加工力 kN (tonf)		Catalog No.	W	θ	圧力源 PS
	100万回 標準	30万回 条件付				
Yellow	90.2 (9.2)	135.3 (13.8)	VACYL	140	00~70 (5°ピッチ)	GK NGK ISO
Pink	127.4 (13.0)	191.1 (19.5)	VACPL			

ISO:Coil Spring GK:Gas Spring (KALLER)
NGK:Gas Spring無 スプリング取付部品は付属します。

Order	Catalog No.	W	θ	PS	Option
	VACYL	140	10	ISO	
	VACPL	140	10	GK	NF-K

Option	オプションコード	仕様
	NF	窒素ガス充填無し。
	K	専用のキーが付属します。

📺 キー詳細P.390参照。

■スプリング力

●Coil Spring仕様
Yellow

θ	初圧		終圧		使用 スプリング
	N	kgf	N	kgf	
00	523	53.4	4636	473	TJM50-178
05	523	53.4	4636	473	TJM50-178
10	523	53.4	4636	473	TJM50-178
15	523	53.4	4636	473	TJM50-178
20	523	53.4	4636	473	TJM50-178
25	523	53.4	4636	473	TJM50-178
30	523	53.4	4636	473	TJM50-178
35	523	53.4	4636	473	TJM50-178
40	523	53.4	4636	473	TJM50-178
45	523	53.4	4636	473	TJM50-178
50	523	53.4	4636	473	TJM50-178
55	438	44.7	4556	465	TJM50-152
60	575	58.7	4505	460	TJM50-139
65	463	47.3	4518	461	TJM50-115
70	784	80.0	4442	453	TJM50-102

Pink

θ	初圧		終圧		使用 スプリング	
	N	kgf	N	kgf		
00	429	43.8	8902	908	TF50-100	TH50-75
05	429	43.8	8902	908	TF50-100	TH50-75
10	429	43.8	8902	908	TF50-100	TH50-75
15	429	43.8	8902	908	TF50-100	TH50-75
20	429	43.8	8902	908	TF50-100	TH50-75
25	429	43.8	8902	908	TF50-100	TH50-75
30	429	43.8	8902	908	TF50-100	TH50-75
35	429	43.8	8902	908	TF50-100	TH50-75
40	429	43.8	8902	908	TF50-100	TH50-75
45	429	43.8	8902	908	TF50-100	TH50-75
50	429	43.8	8902	908	TF50-100	TH50-75
55	393	40.1	8683	886	TF50-90	TH50-75
60	629	64.2	8683	886	TF50-90	TH50-75
65	525	53.6	8412	858	TF50-80	TH50-75
70	443	45.2	8061	823	TF50-70	TH50-75

■スプリング力

●Gas Spring仕様
Yellow, Pink共通

θ	終圧		使用 スプリング
	N	kgf	
00	11162	1139	X750-63
05	11162	1139	X750-63
10	11162	1139	X750-63
15	11162	1139	X750-63
20	11162	1139	X750-63
25	11162	1139	X750-63
30	11162	1139	X750-63
35	11162	1139	X750-63
40	11162	1139	X750-63
45	11162	1139	X750-63
50	11162	1139	X750-63
55	11438	1167	X750-50
60	10911	1113	X750-50
65	11327	1156	X750-38
70	11103	1133	X750-32

■重量

θ	全重量 kg	カムスライダ重量 kg	取付工具重量*1 kg
00	47.3	17.2	12.8
05	46.8	17.2	12.8
10	46.3	17.2	12.8
15	45.9	17.2	12.8
20	45.7	17.2	12.8
25	45.5	17.2	12.8
30	45.3	17.2	12.8
35	45.6	17.2	12.8
40	46.4	17.2	12.8
45	47.8	17.2	12.8
50	49.3	17.2	12.8
55	50.9	18.5	11.5
60	51.7	19.1	10.9
65	53.0	20.3	9.7
70	53.3	20.4	9.6

*1 取付工具重量は目安値です。厳密にはプレス速度により変わります。

■カムストローク

θ	ストローク mm
00	35.4
05	39.0
10	42.8
15	46.6
20	50.7
25	55.0
30	59.7
35	64.9
40	70.7
45	77.5
50	85.6
55	81.9
60	82.0
65	82.8
70	81.9

■後方抜きスペース

●Coil Spring仕様
Gas Spring仕様

θ	L
00	0
05	0
10	0
15	6.8
20	14.1
25	27.5
30	40.7
35	51.7
40	62.3
45	67.5
50	68.3
55	77.2
60	85.8
65	92.7
70	98.8

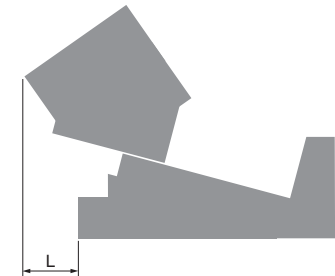

AERIAL CAM UNIT

VACYL140-00
VACPL140-00

CAD
FILE

VACYL140-05
VACPL140-05

CAD
FILE

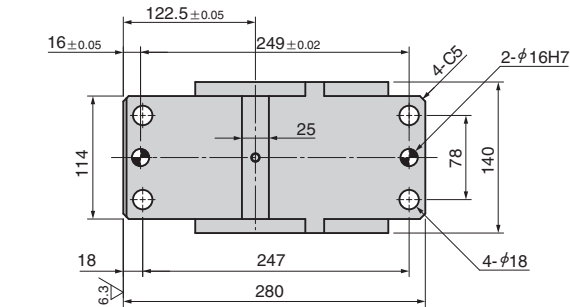

● Cam Diagram

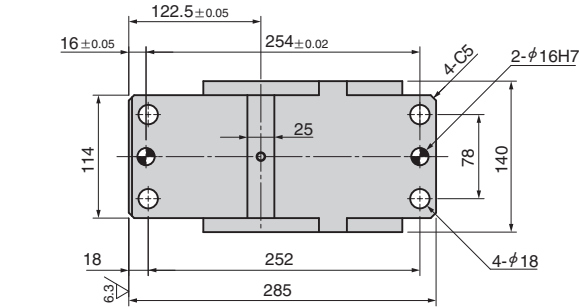
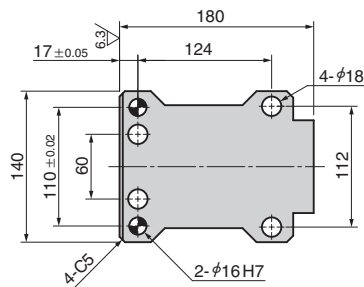
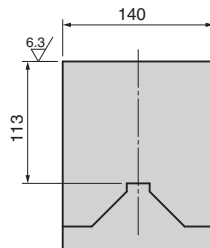
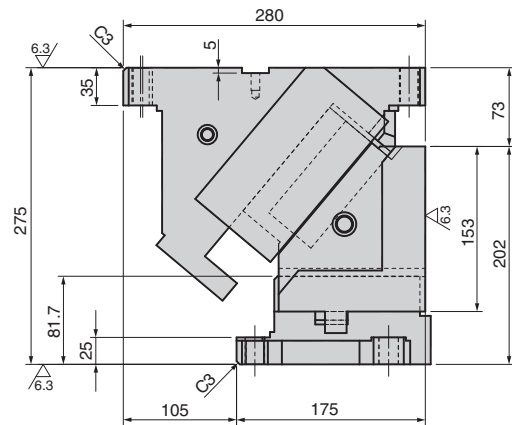
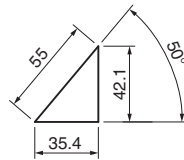

● Cam Diagram

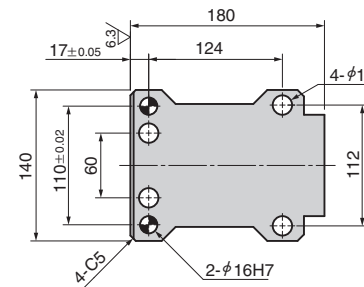
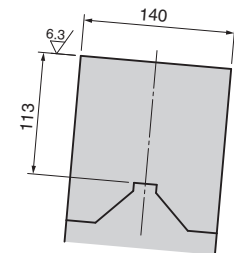
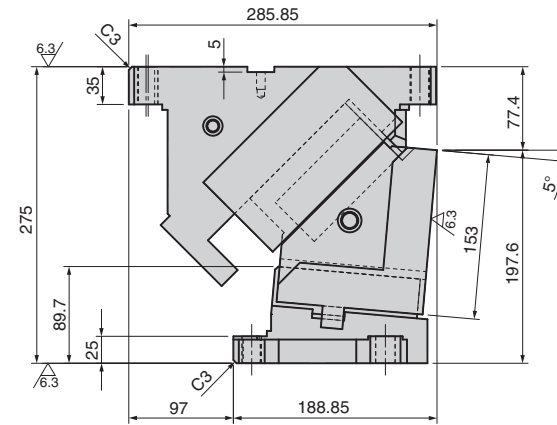
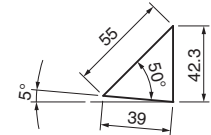

AERIAL CAM UNIT

VACYL140-10
VACPL140-10

CAD
FILE

VACYL140-15
VACPL140-15

CAD
FILE

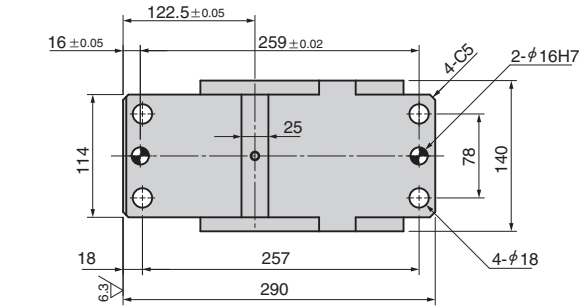

● Cam Diagram

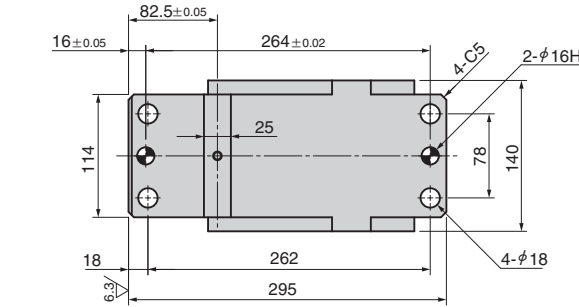
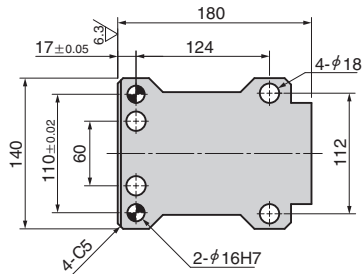
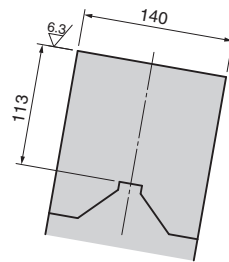
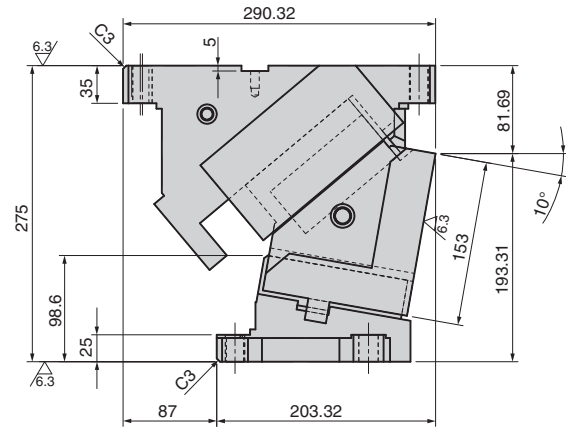
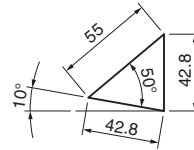

● Cam Diagram

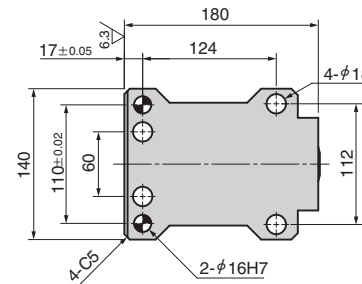
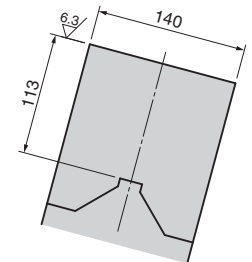
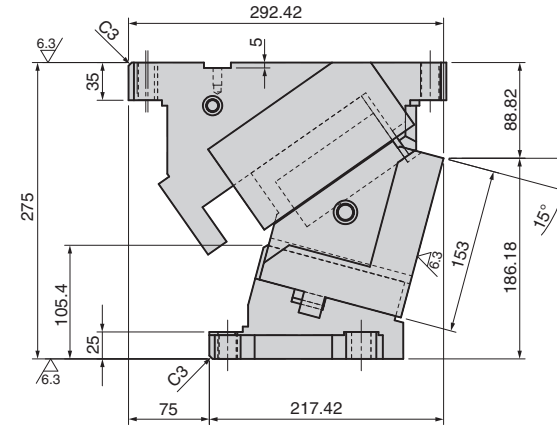
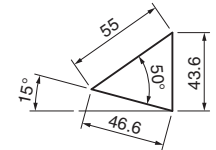

AERIAL CAM UNIT

VACYL140-20
VACPL140-20

CAD
FILE

VACYL140-25
VACPL140-25

CAD
FILE

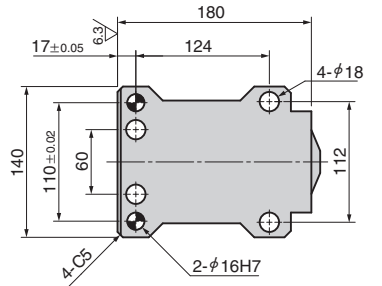
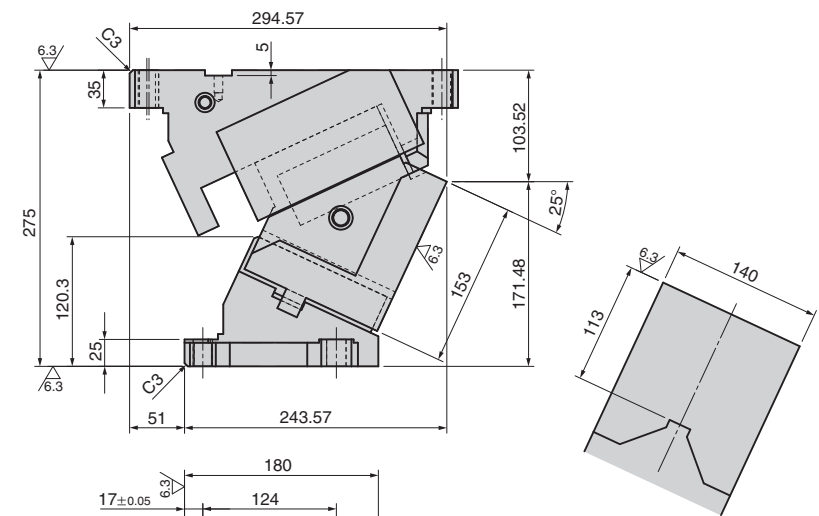
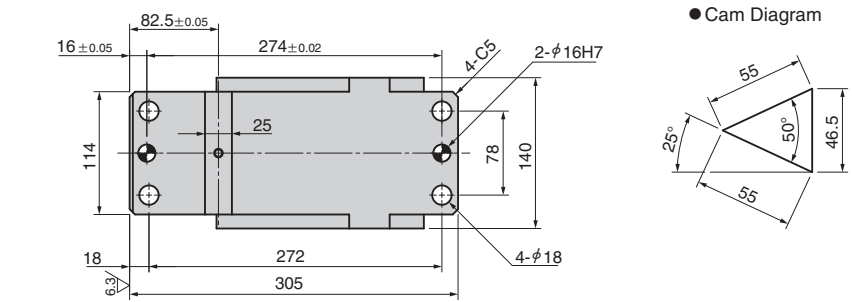
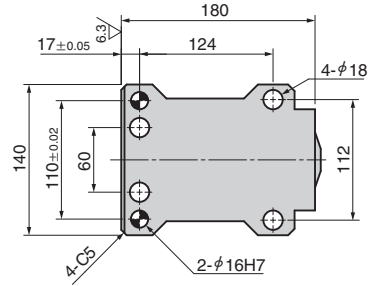
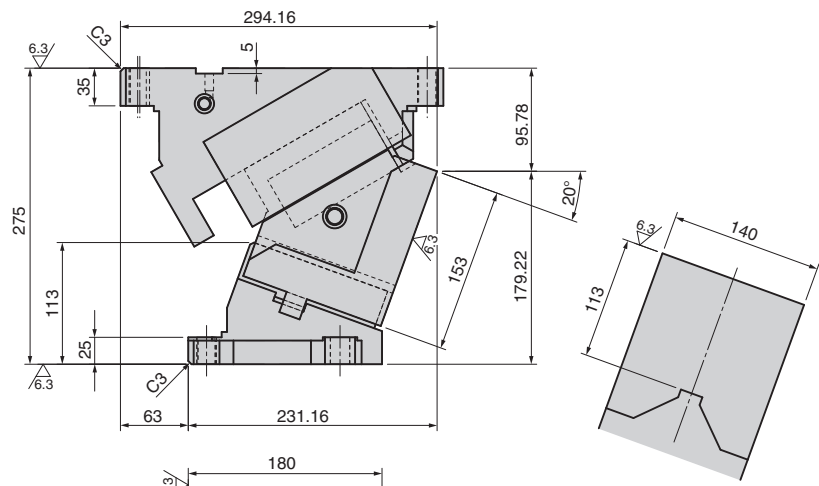
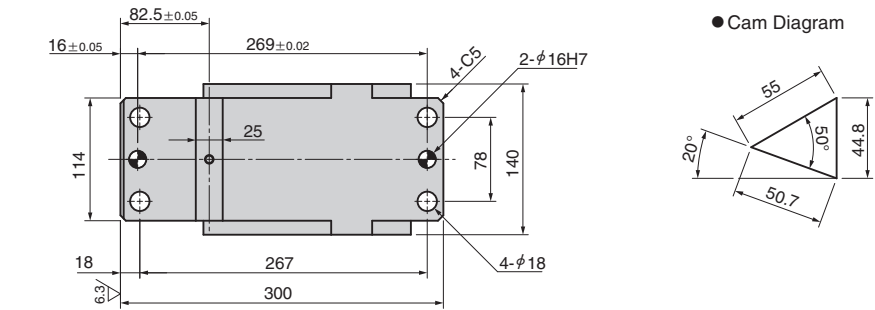

AERIAL CAM UNIT

VACYL140-30
VACPL140-30

CAD
FILE

VACYL140-35
VACPL140-35

CAD
FILE

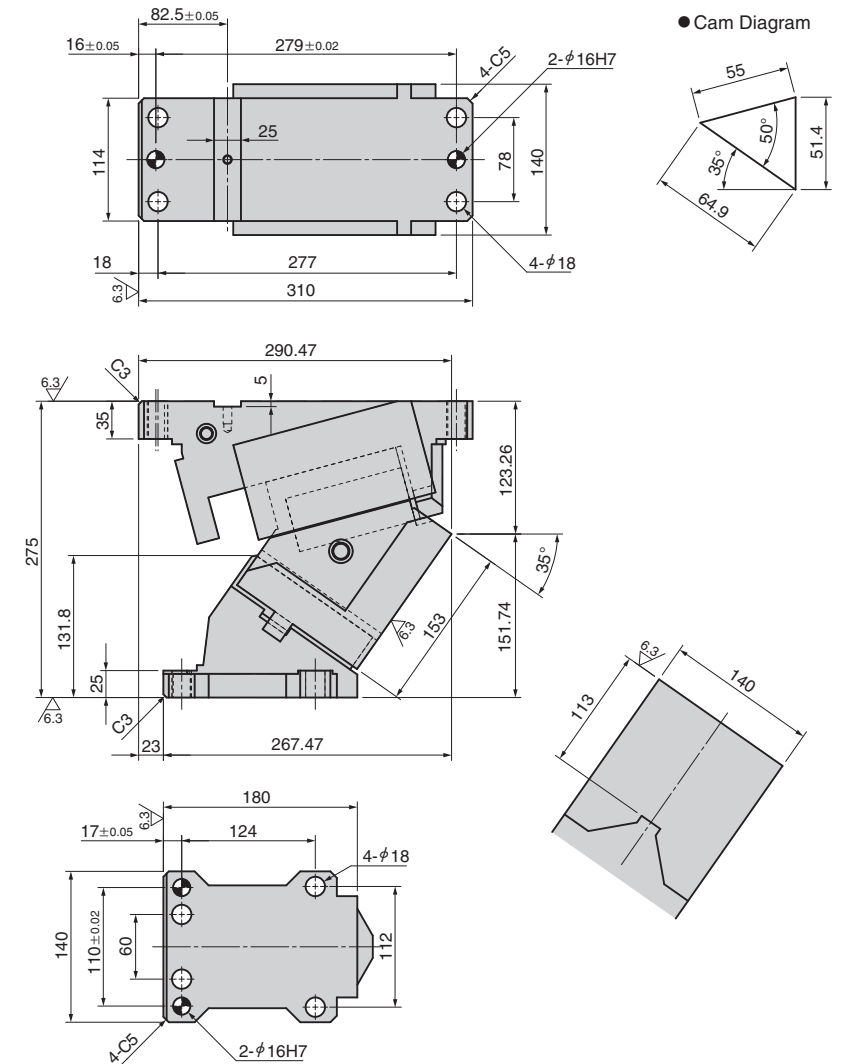
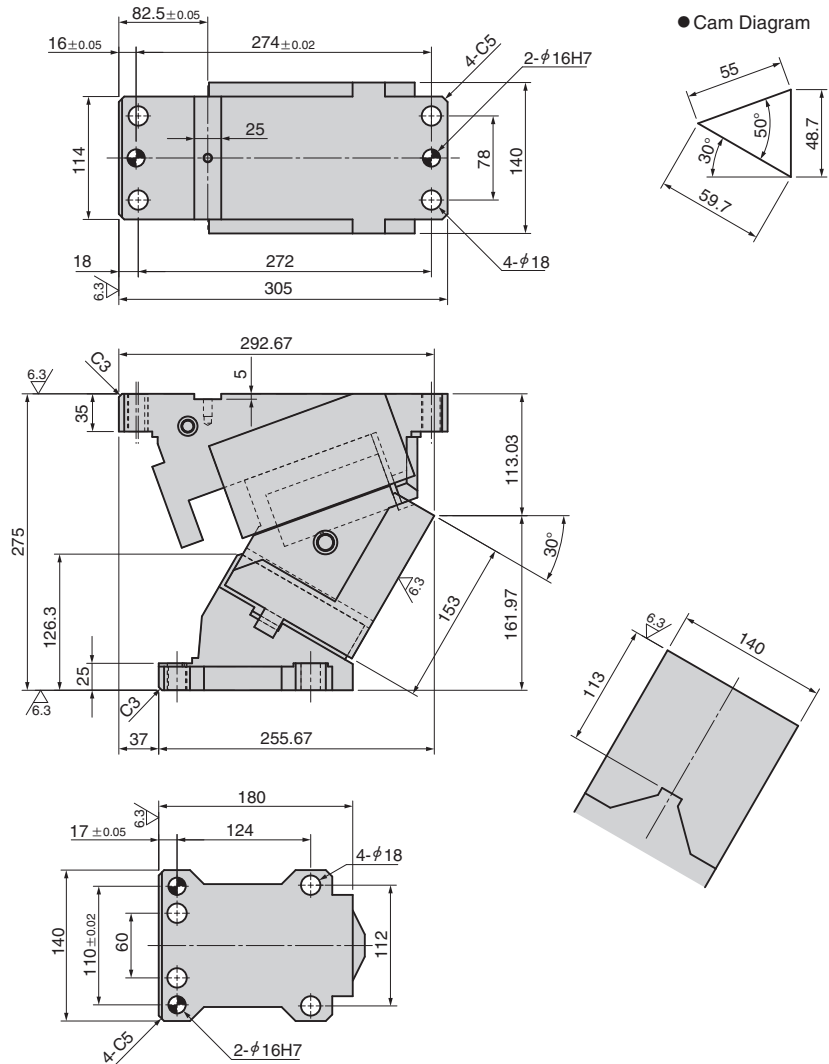

AERIAL CAM UNIT

VACYL140-40
VACPL140-40

CAD
FILE

VACYL140-45
VACPL140-45

CAD
FILE

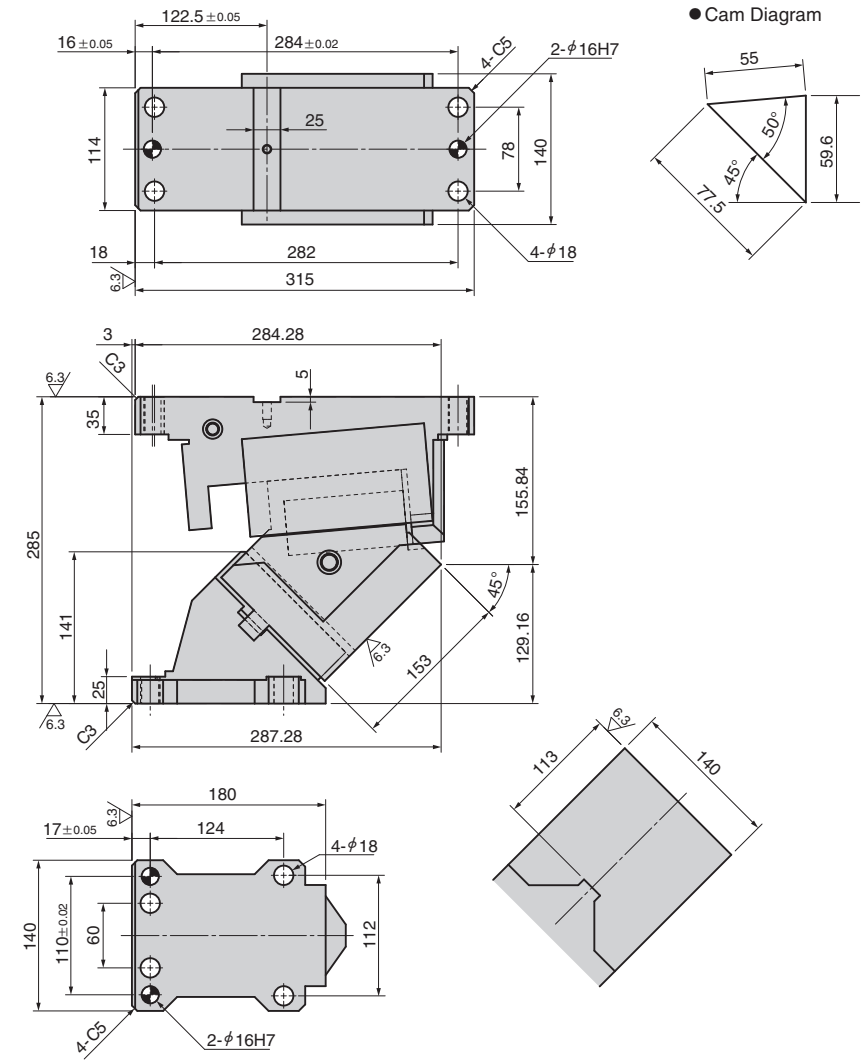
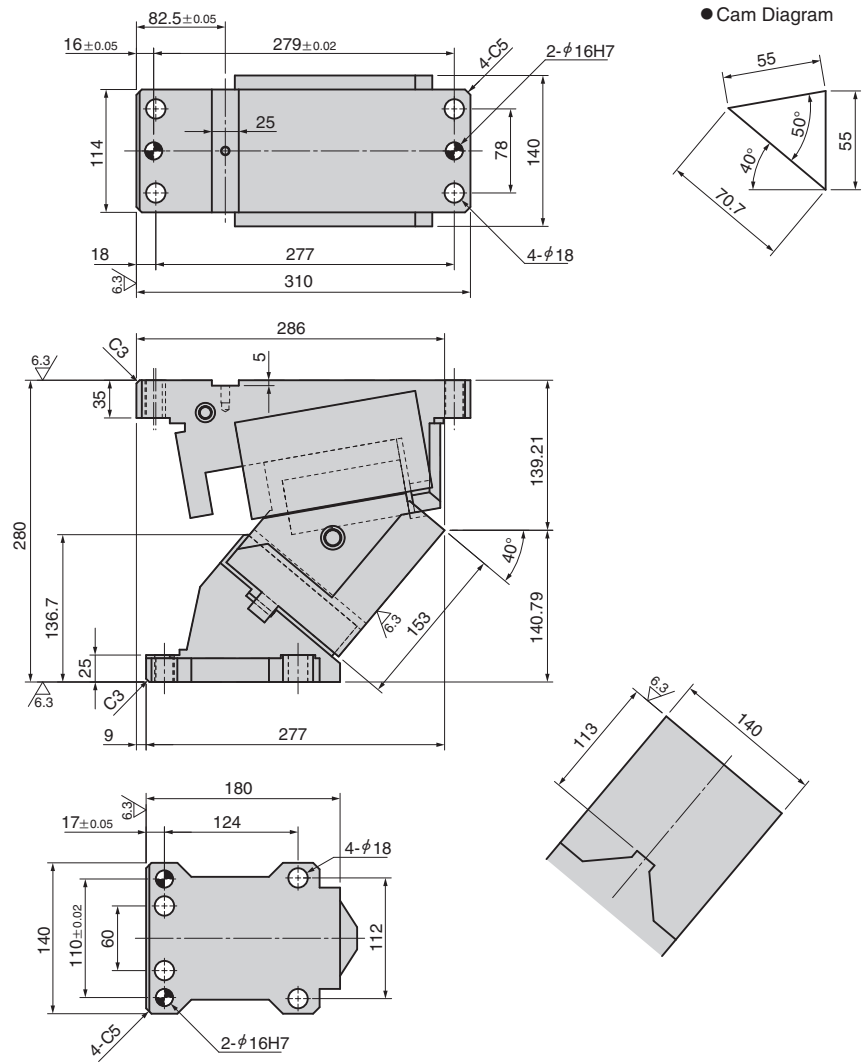

▶ 部品表P.393参照。

▶ 部品表P.393参照。

AERIAL CAM UNIT

VACYL140-50
VACPL140-50

CAD
FILE

VACYL140-55
VACPL140-55

CAD
FILE

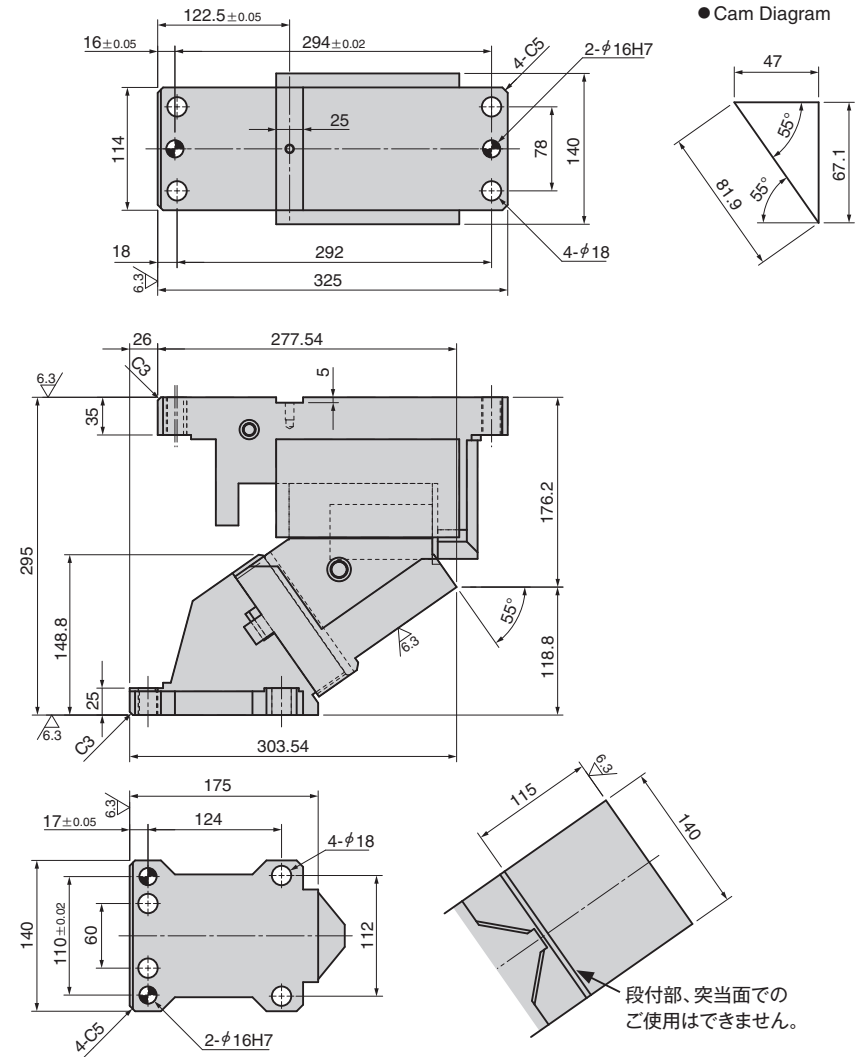
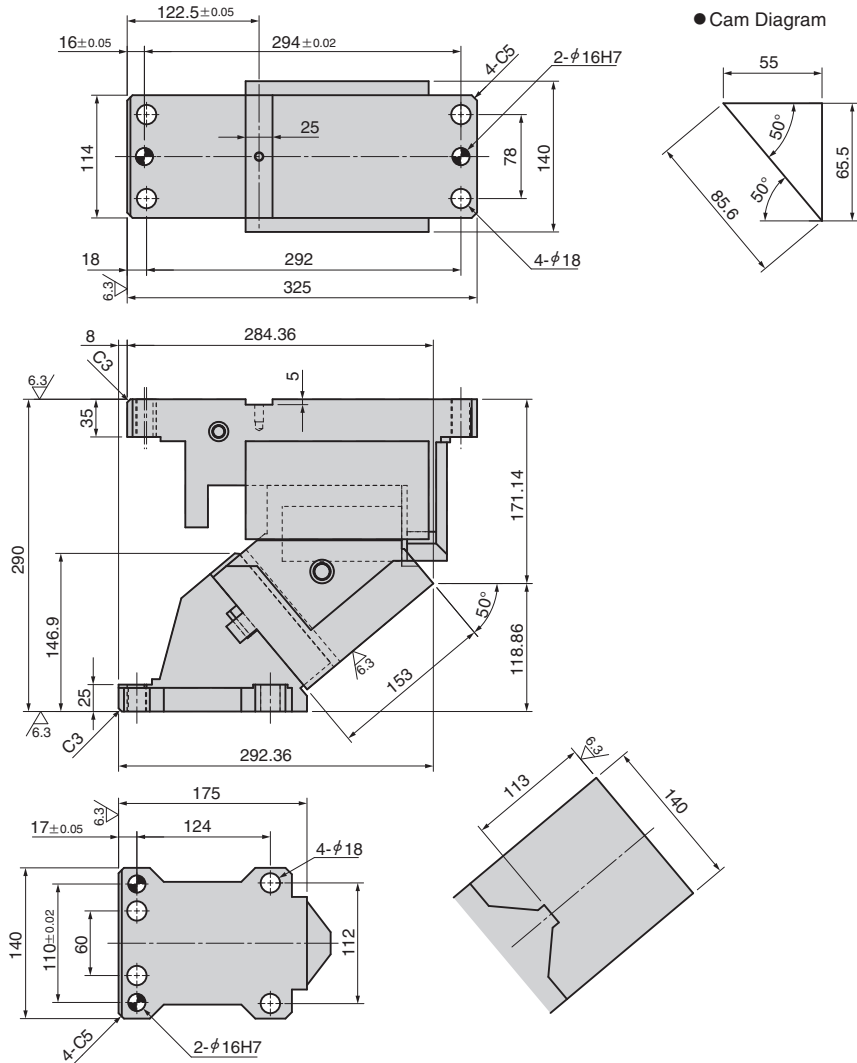

▶ 部品表P.393参照。

▶ 部品表P.393参照。

AERIAL CAM UNIT

VACYL140-60
VACPL140-60

CAD
FILE

VACYL140-65
VACPL140-65

CAD
FILE

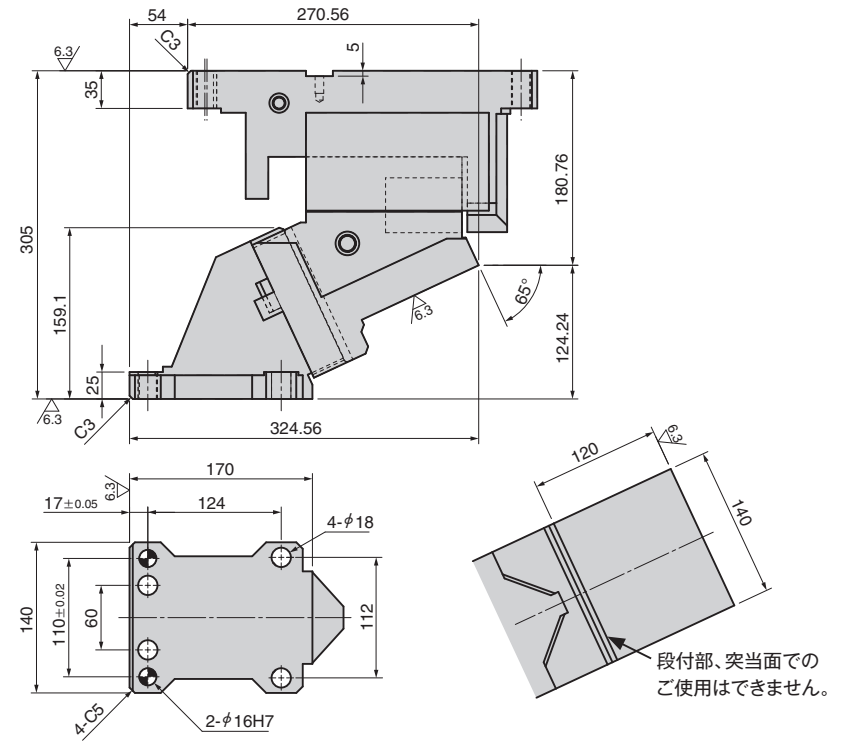
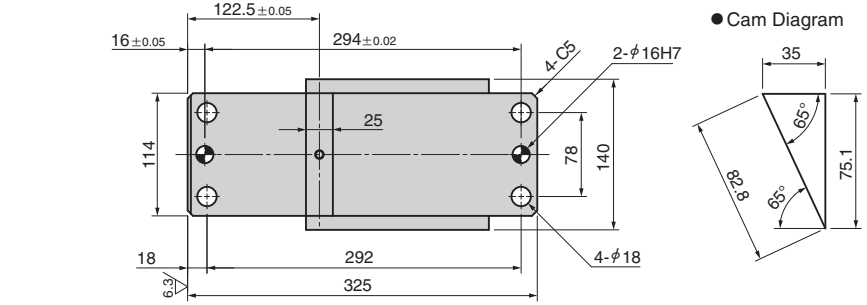
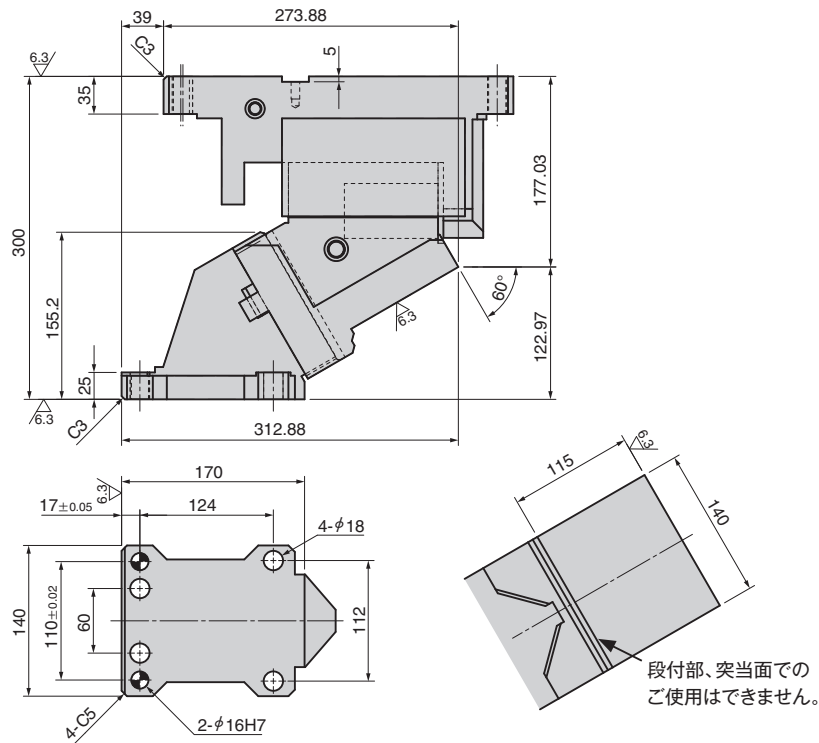
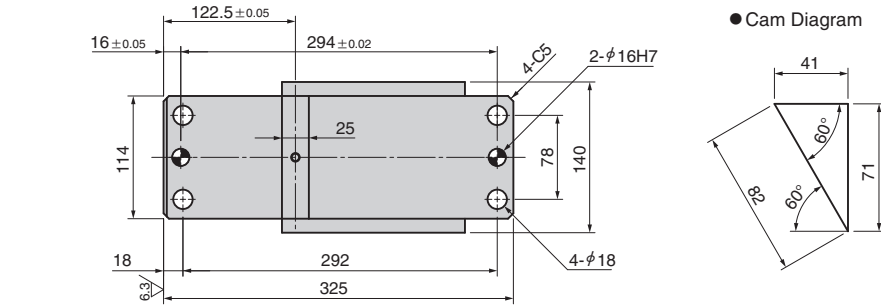

AERIAL CAM UNIT

VACYL140-70
VACPL140-70

