

SOXB

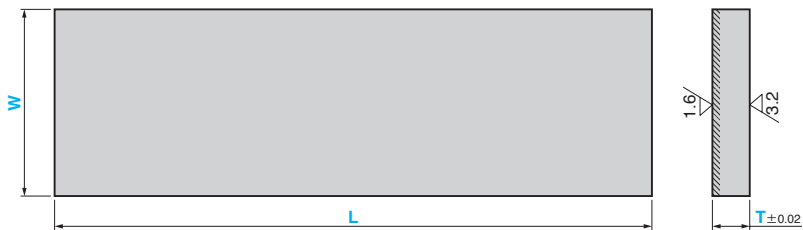

● Sliding Direction



Material : Copper powder sintered (#220)
 Hatched Area Sintered
 Thickness 1.2 mm or more
 Base Plate T=10 S45C (U C45 A 1045)
 T≥20 SS400 (A 36-89b, A283-88)

Recommended Bolt

For M8
 T=10

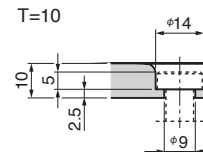

T= 20·25

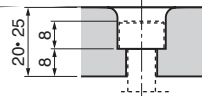

For M10
 T=10

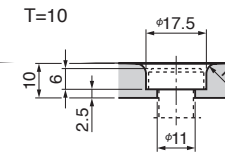

T= 20·25

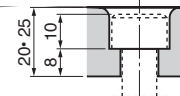

Catalog No.	W	L	T
	75		
	100		10
	125		
SOXB	150	320	
	75		
	100		20
	125		
	150		
	100		25

For Operation:

- Cut or drill the plate as required.
- When the thickness is adjusted, machine the back surface.
- Apply grease for initial lubrication before operation.



Order

Catalog No. **SOXB** W **100** - L **320** - T **10**