

**TWP**  
(Bronze Standard Type)  
**TWPC**  
(Bronze Standard Type  
4-C chamfering Type)

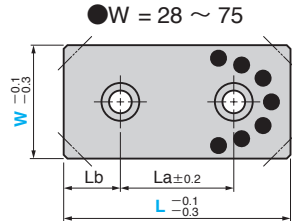

W=28 2-R2  
Chamfering for W38 or more is the same as chamfering for W100 or more.

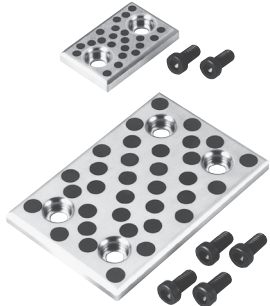
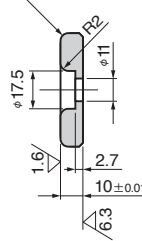

● W = 100 or more

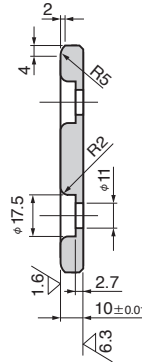
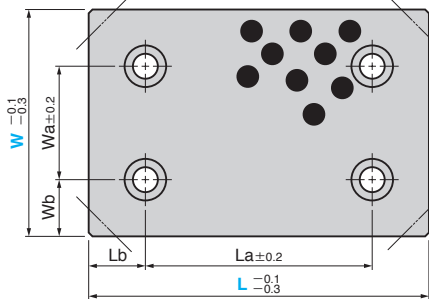

**TWPT**  
(Bronze Standard, 2-Hole Type)  
**TWPTC**  
(Bronze Standard, 2-Hole Type  
4-C chamfering Type)

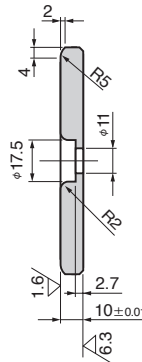
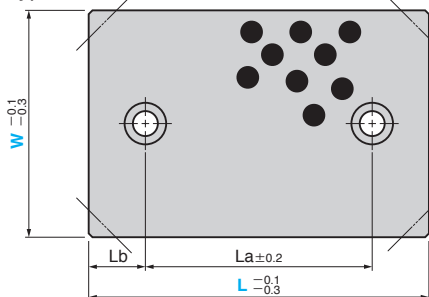
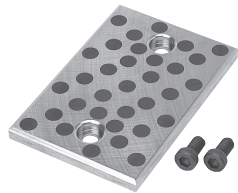

● Sliding Direction  
W = 28 and 38

W = 48 or more

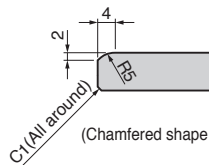

(Chamfered shape at both ends)

Material : Bronze with Graphite (SO#50 SP2)  
Accessory : Mounting bolt

Wa	Wb	La	Lb	Catalog No.	W	L
		45	15			75
		50			28	100
		75	25			125
		100				150
		45	15			75
		50			38	100
		75	25			125
		100				150
		45	15	TWP		75
-	-	50		TWPC		100
		75			48	125
		100				150
		150				200
		25				75
		50			75	125
		75				150
		100				200
		150				250
		50	25			100
		75				125
50	25	100		TWP	100	150
		150		TWPC		200
		200				250
		100		TWPT		150
	37.5	150		TWPTC	125	200
		200				250
100	25	100			150	150
		150				200

Order	Catalog No.	W	-	L
	TWP	75	-	150
	TWPC	48	-	100
	TWPT	100	-	200

● Special brazier head bolt (LCS standard)  
LCS-10-20

● TWPC/TWPTC Details of 4-C chamfering

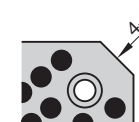
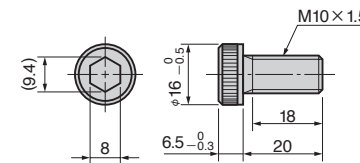

W	Size of chamfering
28	10
38	13
48	
75	
100	17
125	
150	

■ We are ready to accept requests or orders for special parts.