

Guide Pin

FLANGE TYPE

RoHS

RGPA

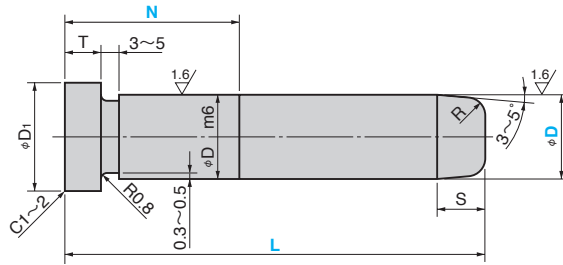

Material : SUJ2
 (B1 A 52100)
 Hardness : HRC58 or more
 Induction Hardened

D	D m6	T	D ₁	S	Catalog No.	D	L (Increments of 5mm)	Press fit area N (Increments of 1mm)
20	20		25		RGPA	20	75~200	8~100
25	25	8	30	5		25	105~300	8~120
30	30		35			30	130~350	8~130
35	35	40	40	35		155~400	8~130	
40	40	10	45	8		40	155~450	10~200
50	50		55		50	12~200		

Order - -
 RGPA 25 - 200 - 50

Guide Pin

STRAIGHT TYPE(TAPPED)

RoHS

RGPL

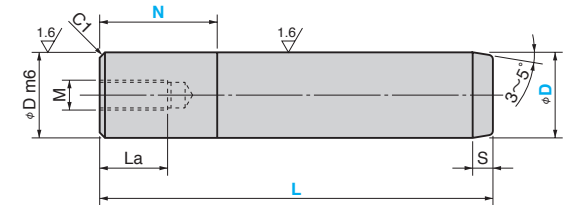

Material : SUJ2
 (B1 A 52100)
 Hardness : HRC58 or more
 Induction Hardened

D	D m6	M x Pitch	La	S	Catalog No.	D	L (Increments of 5mm)	Press fit area N (Increments of 1mm)
20	20	M8 x P1.25	16		RGPL	20	75~225	0~100
25	25					25	75~275	0~100
30	30	M12 x P1.75	24	30		105~300	0~120	
35	35			35		105~300	0~120	
40	40	M16 x P2.0	32	8		40	105~325	0~140
50	50				50	130~400	0~140	
60	60	M20 x P2.5	40		60	180~400	0~200	
80	80				80	180~400	0~200	

Order - -
 RGPL 30 - 200 - 50

Option

Option Code	Specification					
HMC	Tapped hole for lifting is drilled at the end. Applicable to D60 and 80.					
	<table border="1"> <thead> <tr> <th>D</th> <th>Thread diameter (M) x Depth</th> </tr> </thead> <tbody> <tr> <td>60·80</td> <td>M16x32</td> </tr> </tbody> </table>	D	Thread diameter (M) x Depth	60·80	M16x32	
D	Thread diameter (M) x Depth					
60·80	M16x32					
GM	Tapped hole for Assist Pin mounting is drilled at the end. Applicable to D60 and 80.					
	<table border="1"> <thead> <tr> <th>D</th> <th>Thread diameter (M) x Depth</th> </tr> </thead> <tbody> <tr> <td>60</td> <td>M30x35</td> </tr> <tr> <td>80</td> <td>M36x45</td> </tr> </tbody> </table>	D	Thread diameter (M) x Depth	60	M30x35	80
D	Thread diameter (M) x Depth					
60	M30x35					
80	M36x45					

Refer to page. 20 for the assist pin details.



•GM specification

D	d
60	36
80	41

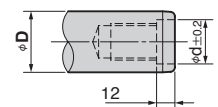

Order - - -
 RGPL 60 - 300 - 75 - GM