

GP DIN 9833

● D = $\phi 25 \sim \phi 63$

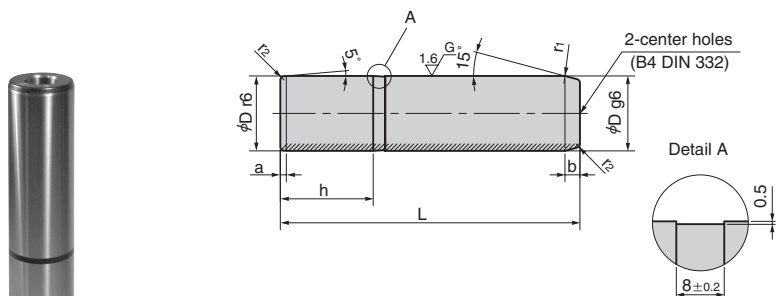

● D = $\phi 80 \sim \phi 160$

GP DIN9833-D x L (Hanging tap type)



▲ Freeze the press fit area (Dr6) to -80°C for fitting.

GP DIN9833-D x L-H (Hollow type)

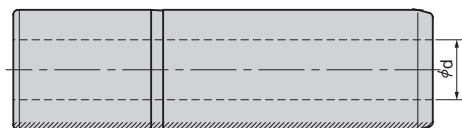

Solid type Material : 42CrMoV (S53C)

Hardness : HRC60~64(Hatched Area)
(Depth 1.0mm or more)

Hollow type Material : 1.3536 (S53C)

Hardness : HRC60~64(Hatched Area)
(Depth 1.0mm or more)

D	Tolerance		h	a	b	r1	r2	d
	g6	r6						
25	-0.007 -0.020	+0.041 +0.028	40					
32			45		8	3	2	
40	-0.009 -0.025	+0.050 +0.034	56					-
50			70	4		5	2.5	
63	-0.010 -0.029	+0.060 +0.041	80		10	6		
80			100			8	3	40
100	-0.012 -0.034	+0.073 +0.051	125			10		50
125			140			12		65
160	-0.014 -0.039	+0.088 +0.063	180	5	12	18	4	95

Catalog No.	D	L
		125
	25	140
		160
		180
		140
	32	160
		180
		200
		140
		160
		180
GP(GUIDE POST) DIN9833	40	200
		224
		250
		280
		160
		180
		200
	50	224
		250
		280
		315
		355

Catalog No.	D	L
		180
		200
		224
	63	250
		280
		315
		355
		400
		224
		250
		280
GP(GUIDE POST) DIN9833	80	315
		355
		400
		280
		315
	100	355
		400
		315
		355
	125	400
		450
		500
		400
	160	450
		500
		560



Order

Catalog No. - D X L

GP DIN9833 - 50 X 250

GP DIN9833 - 80 X 280

GP DIN9833 - 80 X 400

(Hanging tap type)

- H (Hollow type)