

Cam Gib Plate

Sintered Type

Cam Slide Components

MCUX

CAD
FILE



● L=150, 200

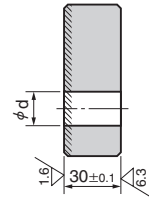
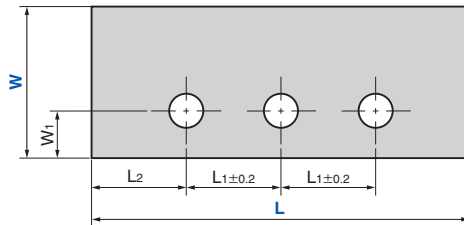

● L=250

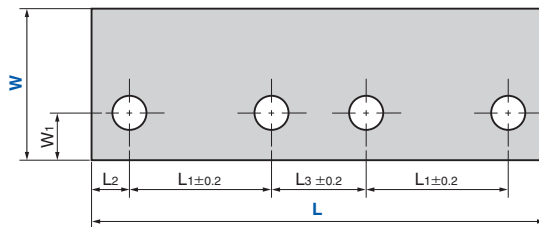

〈Material〉 SO#220
Hatched Area Sintered
Thickness 1.2 mm or more
SS400 (base plate)

Catalog No.	W	L	L ₁	L ₂	L ₃	W ₁	d
MCUX	82	150	50	25	—	25	18
		200	75		—		
		250		50			



Catalog No.	W	—	L
MCUX	82	—	200