

Wear Plate

Thickness 20 mm Sintered Type

Slide Components

SOX (Sintered and Standard Type)

CAD FILE

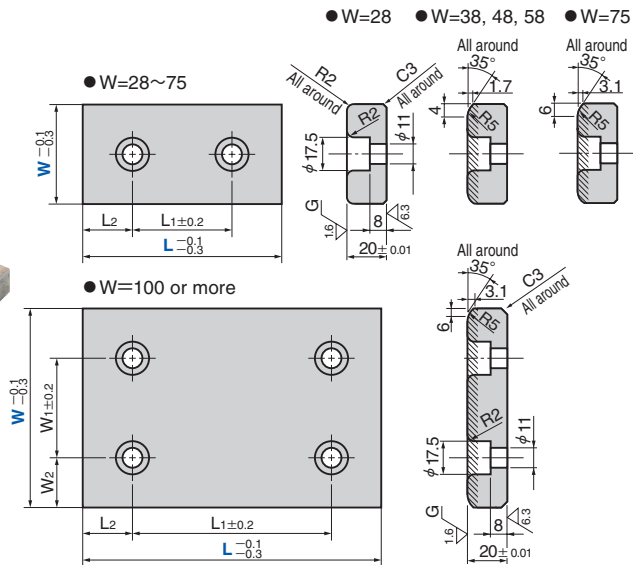

● For W=75, L=250

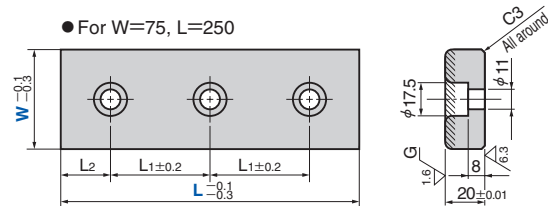

SOXT (Sintered 2-Hole Type)

CAD FILE

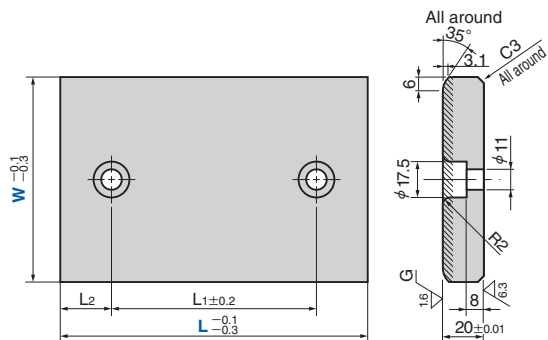

● Sliding Direction



(Material) SO#220
Hatched Area Sintered
Thickness 1.2 mm or more
SS400 (base plate)

Catalog No.	W	L		W ₁	W ₂	L ₁	L ₂	
		SOX	SOXT					
SOX	28	75				45	15	
		100				50	25	
		150				100	25	
	38	75					45	15
		100					50	
		125					75	25
	48	150					100	
		200					150	
		250					200	
	58	75					45	15
		100					50	
		150					100	
75	75					45	15	
	100					50		
	125					75	25	
100	150					100		
	200					150		
	250					200		
	300					250		
	100	100				50		
	125	125				75		
SOX SOXT	125	150	150			100	25	
		200	200	50	37.5	150		
		250	250			200	50	
150	150	150				100		
	200	200			100	25		
	250	250			200			



Catalog No.	W	-	L
SOX	48	-	75
SOXT	125	-	150