

**LWM**

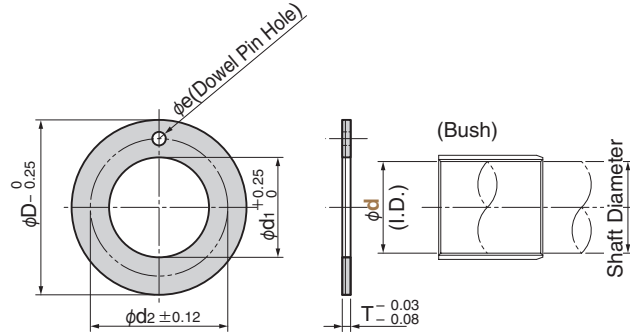

Material SO#936 FR

Bush I.D. $\phi d$	$d_1$	D	T Thickness	$d_2$	e	Housing Depth	Catalog No.	d
6	8	16		12	1.300			<b>06</b>
8	10	18		14	~1.100			<b>08</b>
10	12	24		18	1.875 ~1.625			<b>10</b>
12	14	26		20				<b>12</b>
14	16	30		23	2.375 ~2.125			<b>14</b>
16	18	32		25				<b>16</b>
18	20	36	1.5	28		1.20		<b>18</b>
20	22	38		30	3.375	~0.95	<b>LWM</b>	<b>20</b>
22	24	42		33	~3.125			<b>22</b>
24	26	44		35				<b>24</b>
25	28	48		38				<b>25</b>
30	32	54		43				<b>30</b>
35	38	62		50	4.375			<b>35</b>
40	42	66		54	~4.125			<b>40</b>
45	48	74	2.0	61		1.70		<b>45</b>
50	52	78		65		~1.45		<b>50</b>



Order

Catalog No.

**LWM**

d

**30**

■ For Operation

- When a dowel pin is used for retention.  
Provide a step down on housing. Make step down dia larger by 0.05 to 0.15 mm. than thrust washer O.D. Make dowel pin top lower by 0.3 to 0.5 mm than washer face.
- When adhesive is used for retention.  
Adhesives can be used for thrust washer retention but in this case take the max.usable temperature and running condition into consideration for adhesive selection.

