

UCMSV85 (50°~75°)

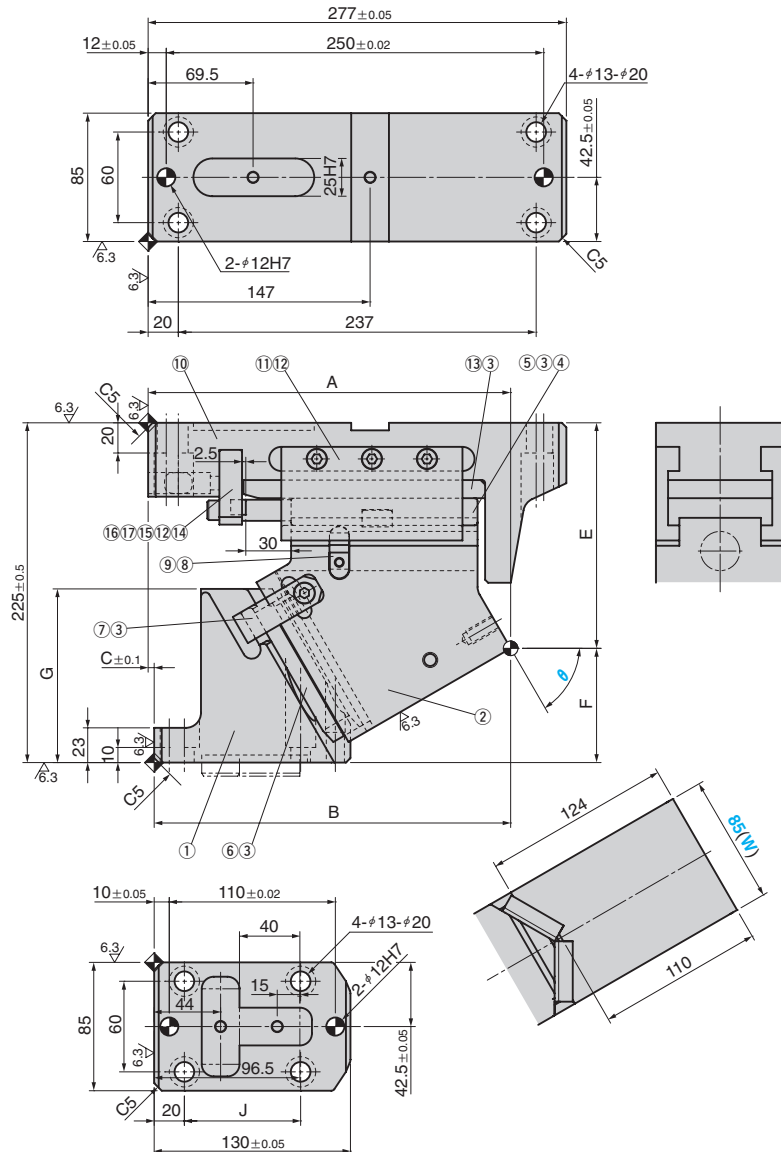

θ	Travel	A	B	C	E	F	G	S	J
50	46.7	249.24	229.24	20	133.48	91.52	115		
55	52.3	250.67	231.67	19	140.79	84.21	110		
60	60.0	240.1	236.1	4	149.35	75.65	115	30	77
65	71.0	235	240	-5	159.05	65.95			
70	58.5	230	245	-15	168.88	56.12	120		80
75	77.3	228	253	-25	186.99	38.01	135	20	90

Working Force kN	Catalog No.	(W)	θ	Spring Type PS
100	UCMSV	85	50	
			55	GS
			60	GK
			65	GD
			70	*NGP
			75	

Mark *
Without gas spring but accessories for installation of each type are included.

Order **Catalog No.** **(W)** - **θ** - **PS**
UCMSV 85 - 60 - GK

Spring Specification (Qty 1)

Spring Type PS	θ	Spring Force N			Gas Spring Catalog No.
		F _A	F _E	F _{AP}	
GS	50~65	3200	6210	5576	SFC.320.38 (SANKYO)
	70~75			5608	SFC.320.25 (SANKYO)
GK	50~65	3200	5300	4858	X320-038-TD (KALLER)
	70~75		5200	4800	X320-025-TD (KALLER)
GD	50~65	3200	4940	4574	U.0325.038 (DADCO)
	70~75			4592	U.0325.025 (DADCO)

NOTE
 F_A :Initial Force
 F_E :Final Force
 F_{AP} :Force at working point



Option

Code	Specification
K	with key
NF	without nitrogen gas



Order **UCMSV85 - 60 - GK - NF**

- Parts list is shown in p.1505
- Detail of key is shown in p.1504
- Cam diagram is shown in p.1503
- NF : Gas Springs are not filled with nitrogen gas if delivery is by air freight.

UCMSV85 Aerial Cam Unit Table of Components

FOR PIERCE
■ $\theta = 00^\circ \sim 65^\circ$

No.	Description	Qty	Material and Remark
①	Cam Driver	1	GGG60
②	Cam Slider	1	GGG60
③	Hexagon Socket Head Bolt	16	SCM435 M8×15
④	Dowel Pin with Female Thread	2	SUJ2 $\phi 8 \times 25$
⑤	Slide Plate	1	S45C
⑥	Slide Plate(VSM-18)	2	Bronze with Graphite
⑦	Positive Return	2	S45C
⑧	Spring Stopper Plate	2	S45C
⑨	Hexagon Socket Head Bolt	2	SCM435 M8×45
⑩	Cam Holder	1	GGG60
⑪	Slide Keeper	2	Bronze with Graphite
⑫	Hexagon Socket Head Bolt	8	SCM435 M8×20
⑬	Slide Plate (VSM-29)	1	Bronze with Graphite
⑭	Stopper Plate	1	S45C
⑮	Stopper	2	Urethane
⑯	Lock Block-00-65	1	SS400
⑰	Hexagon Socket Head Bolt	1	SCM435 M8×60
⑱	Gas Spring	1	
⑲	Key	3	SS400
⑳	Key	1	SS400

■ $\theta = 70^\circ \sim 75^\circ$

No.	Description	Qty	Material and Remark
①	Cam Driver	1	GGG60
②	Cam Slider	1	GGG60
③	Hexagon Socket Head Bolt	16	SCM435 M8×15
④	Dowel Pin with Female Thread	2	SUJ2 $\phi 8 \times 25$
⑤	Slide Plate	1	S45C
⑥	Slide Plate(VSM-17)	2	Bronze with Graphite
⑦	Positive Return	2	S45C
⑧	Spring Stopper Plate	2	S45C
⑨	Hexagon Socket Head Bolt	2	SCM435 M8×60
⑩	Cam Holder	1	GGG60
⑪	Slide Keeper	2	Bronze with Graphite
⑫	Hexagon Socket Head Bolt	8	SCM435 M8×20
⑬	Slide Plate (VSM-28)	1	Bronze with Graphite
⑭	Stopper Plate	1	S45C
⑮	Stopper	2	Urethane
⑯	Lock Block-70-75	1	SS400
⑰	Hexagon Socket Head Bolt	1	SCM435 M8×55
⑱	Gas Spring	1	
⑲	Key	3	SS400
⑳	Key	1	SS400