

Oilless Slide Plate FC Type Thickness 20mm

SO#50F

RoHS

SESF

●W=28~75

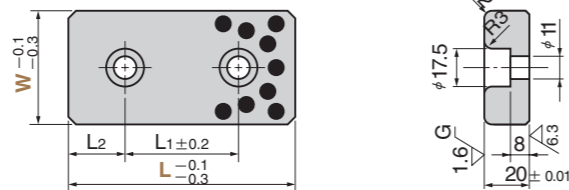

●W=100 or more

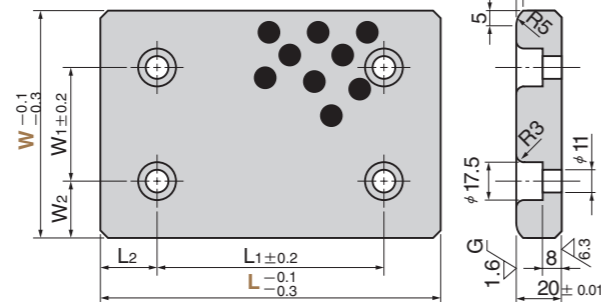

●For W=75 and L=300

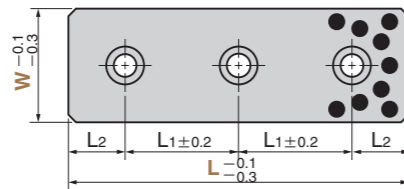

●W=100 · 125 · 150

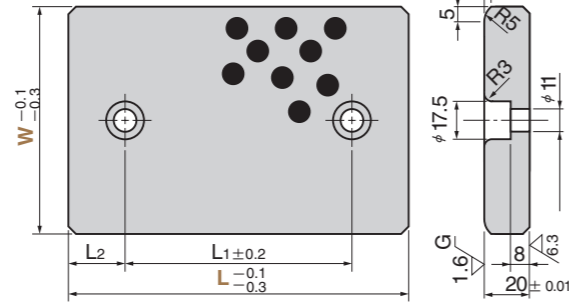

SESF
(FC, 2-Hole Type)



●Sliding Direction

W=28·38



W=48 or more

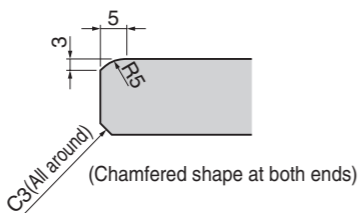

⚠ When the product is used at high temperature (150°C or more), the embedding specification of solid lubricant is different. Please contact us for details.

Material Base FC250 or equivalent Solid lubricant(GR-1)

Operation Range

Lubricant Type	Lubricating Condition	Environment Condition	Max. Allowable Load P N/mm ²	Max. Allowable Sliding Speed V m/min	Max. Allowable PV value N/mm ² ·m/min	Operation Range Temperature °C
GR-1	No lubrication	Atmosphere	5	10	30	-50~+300
	Regular lubrication(Grease)			15	50	-50~+150

Physical Properties

Specific Gravity g/cm ³	Hardness HB	Elongation %	Tensile Strength N/mm ²	Linear Expansion Coefficient ×10 ⁻⁵ /°C
7.1~7.3	150~200	—	150~250	1.0

W1	W2	L1	L2	Catalog No.	W	L	
						SESF	SESFT
		45	15			75	
		50				100	
		75			28	125	
		100	25			150	
		150				200	
		45	15			75	
		50				100	
		75			38	125	
		100	25			150	
		150				200	
		45	15			75	
		50				100	
		75			48	125	
		100	25	SESF		150	
		150				200	
		45	15			75	
		50				100	
		75			58	125	
		100				150	
		25				75	
		50	25			100	
		75				125	
		100			75	150	
		150				200	
		200				250	
		100	50			300	
		50				100	100
		75				125	125
		100	25		100	150	150
50	25	150				200	200
		200				250	250
		200	50			300	—
		75				125	125
		100			SESF	150	150
		150	25		SESF	200	200
50	37.5	200				250	250
		200	50			300	—
		100				150	150
		150			150	200	200
100	25	200				250	250
		250	25			300	300
		150				200	
		200			SESF	250	—
150	25	250				300	

*W1 and W2 are the dimensions only for SESF (W=100 or more).

Order	Catalog No.	W	—	L
	SESF	48	—	150
	SESFT	150	—	150

■ We are ready to accept requests or orders for special parts.