

# Oiless Slide Plate

Bronze Type Thickness 10mm

SO#50SP2

RoHS

**TWP**

●W = 28~75

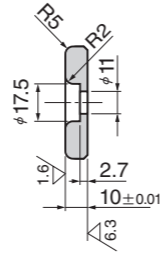
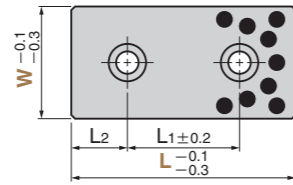

●W = 100 or more

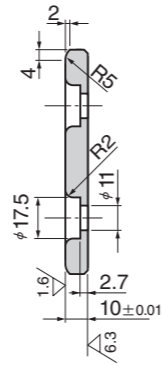
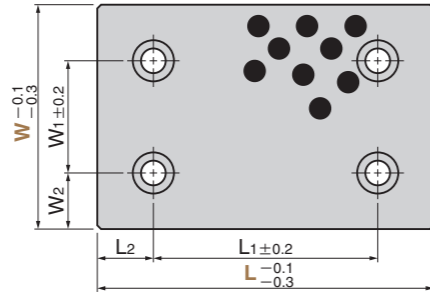

**TWPT  
(Bronze, 2-Hole Type)**

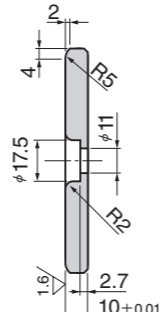
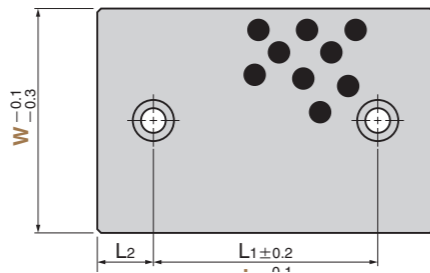

●Sliding Direction

W = 28·38



W = 48 or more



⚠ When the product is used at high temperature (150°C or more), the embedding specification of solid lubricant is different. Please contact us for details.

Material Base Bronze with Graphite(SP2)  
Solid lubricant(GR-1)  
Accessory Mounting Bolt

**Operation Range**

Lubricant Type	Lubricating Condition	Environment Condition	Max. Allowable Load P N/mm <sup>2</sup>	Max. Allowable Sliding Speed V m/min	Max. Allowable PV value N/mm <sup>2</sup> ·m/min	Operation Range Temperature °C
GR-1	No lubrication	Atmosphere	100	15	150	-50~+300
	Regular lubrication(Grease)			30	200	-50~+150

**Physical Properties**

Specific Gravity g/cm <sup>3</sup>	Hardness HB	Elongation %	Tensile Strength N/mm <sup>2</sup>	Linear Expansion Coefficient ×10 <sup>-5</sup> /°C
7.9	210 or more	12 or more	755 or more	1.9

W <sub>1</sub>	W <sub>2</sub>	L <sub>1</sub>	L <sub>2</sub>	Catalog No.	W	L
		45	15			75
		50			28	100
		75	25			125
		100				150
		45	15			75
		50			38	100
		75	25			125
		100				150
		45	15			75
		50				100
		75	25			125
		100				150
		45	15			75
		50				100
		75	25			125
		100				150
		150				200
		45	15			75
		50				100
		75	25			125
		100				150
		150				200
		50				100
		75	25			125
		100				150
		150				200
		50				100
		75	25			125
		100				150
		150				200
	25	100			100	150
		150				200
50		200			TWP	250
		100			TWPT	150
	37.5	150				125
		200				250
100		100				150
	25	150				200

\*W<sub>1</sub> and W<sub>2</sub> are the dimensions only for TWP (W=100 or more).



Order	Catalog No.	W	L
	TWP	38	75
	TWPT	100	150

●Special brazier head bolt(LCS standard)  
LCS-10-20

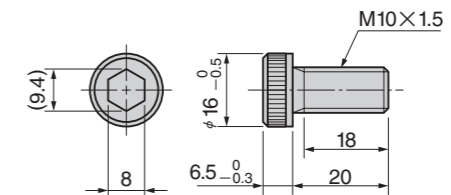

■We are ready to accept requests or orders for special parts.