

# Oilless Thrust Bush

Bronze · I.D. E7 · O.D. r6 Type

SO#50SP2

RoHS

SOSB

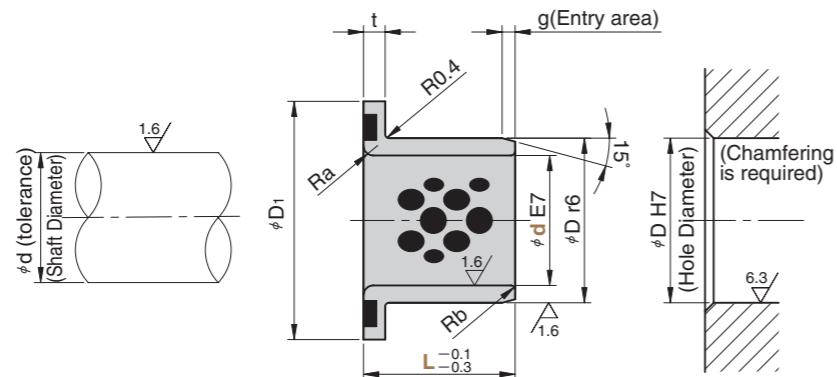

• Mating post tolerance

- d8: General use (high load)
- e7: General use (light load)
- f7: High precision

• Other operating conditions and characteristics

- Can be used in the atmosphere and fresh water (on condition).
- Good performance in operation under high load and at low speed.

⚠ When the product is used at high temperature (150°C or more), the embedding specification of solid lubricant is different. Please contact us for details.

Material  
Base Bronze with Graphite (SP2)  
Solid lubricant (GR-1)

• Sliding Direction



■ Operation Range

Lubricant Type	Lubricating Condition	Environment Condition	Max. Allowable Load P N/mm <sup>2</sup>	Max. Allowable Sliding Speed V m/min	Max. Allowable PV value N/mm <sup>2</sup> · m/min	Operation Range Temperature °C
GR-1	No lubrication	Atmosphere	100	15	150	-50 ~ +300
	Regular lubrication (Grease)			30	200	-50 ~ +150

■ Physical Properties

Specific Gravity g/cm <sup>3</sup>	Hardness HB	Elongation %	Tensile Strength N/mm <sup>2</sup>	Linear Expansion Coefficient ×10 <sup>-7</sup> /°C
7.9	210 or more	12 or more	755 or more	1.9

d E7	D r6	D <sub>1</sub>	t	Ra	Rb	g	Tolerance d after press-fit	Catalog No.	d	L
12	18	+0.034 +0.023	30				+0.035 +0.016		12	11
15	21								15	13
16	22		35	3					16	13
18	24	+0.041 +0.028	40		1	1	+0.028 +0.009		18	18
20	28		45				+0.039 +0.017		20	20
25	33		50						25	20
30	38		55	5		2	+0.034 +0.012		30	25
35	44	+0.050 +0.034	65				+0.048 +0.022	SOSB	35	25
						2				35
										27
40	50		70	7	3		+0.045 +0.019		40	37
										47
										38
50	62	+0.060 +0.041	90		2		+0.038 +0.012		50	48
				8						58
60	74	+0.062 +0.043	110				+0.052 +0.021		60	38
										68
70	85		120		3	3			70	50
		+0.073 +0.051		10			+0.045 +0.014			80
80	96		140						80	60
										90

Order **Catalog No.** **d** - **L**  
SOSB 16 - 13