

# Oilless Bush

Bronze Straight Type

SO#50SP2

RoHS

SOB

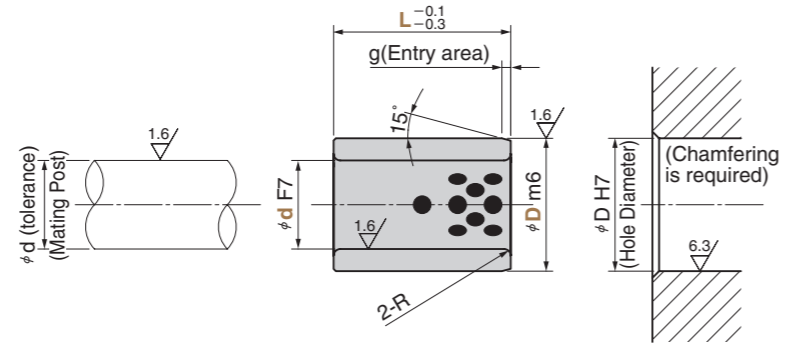

- Mating post tolerance  
d8:General use(high load)  
e7:General use(light load)  
f7 :High precision
- Other operating conditions and characteristics  
· Can be used in the atmosphere and fresh water (on condition).  
· Good performance in operation under high load and at low speed.

●Sliding Direction



⚠ When the product is used at high temperature (150 °C or more), the embedding specification of solid lubricant is different. Please contact us for details.

Material Base Bronze with Graphite(SP2)  
Solid lubricant(GR-1)

■Operation Range

Lubricant Type	Lubricating Condition	Environment Condition	Max. Allowable Load P N/mm <sup>2</sup>	Max. Allowable Sliding Speed V m/min	Max. Allowable PV value N/mm <sup>2</sup> ·m/min	Operation Range Temperature °C
GR-1	No lubrication	Atmosphere	100	15	150	-50~+300
	Regular lubrication(Grease)			30	200	-50~+150

■Physical Properties

Specific Gravity g/cm <sup>3</sup>	Hardness HB	Elongation %	Tensile Strength N/mm <sup>2</sup>	Linear Expansion Coefficient ×10 <sup>-5</sup> /°C
7.9	210 or more	12 or more	755 or more	1.9

Order **Catalog No.** SOB **d** 18 - **D** 24 - **L** 40

d F7	D m6	R	g	Applicable Washer	Catalog No.	d	D	L
8	12	0.5	1	SOBW10	SOB	8	12	8
								10
								12
								15
10	14	1	1	SOBW10	SOB	10	14	8
								10
								12
								15
12	18	0.5	1	SOBW12	SOB	12	18	8
								10
								12
								15
13	19	0.5	1	SOBW13	SOB	13	19	10
								12
								15
								20

d F7	D m6	R	g	Applicable Washer	Catalog No.	d	D	L
14	20	0.5	1	SOBW14	SOB	14	20	10
								12
								15
								20
15	21	0.5	1	SOBW15	SOB	15	21	10
								12
								15
								16
16	22	0.5	1	SOBW16	SOB	16	22	10
								12
								15
								16
17	23	0.5	1	SOBW17	SOB	17	23	10
								12
								15
								16
18	24	+0.021 +0.008	1	SOBW18	SOB	18	24	10
								12
								15
								16
19	26	0.5	1	SOBW19	SOB	19	26	10
								12
								15
								20
20	28	0.5	2	SOBW20	SOB	20	28	10
								12
								15
								16
22	32	+0.025 +0.009	1	SOBW22	SOB	22	32	10
								12
								15
								20

# Oilless Bush

Bronze Straight Type

SO#50SP2

RoHS

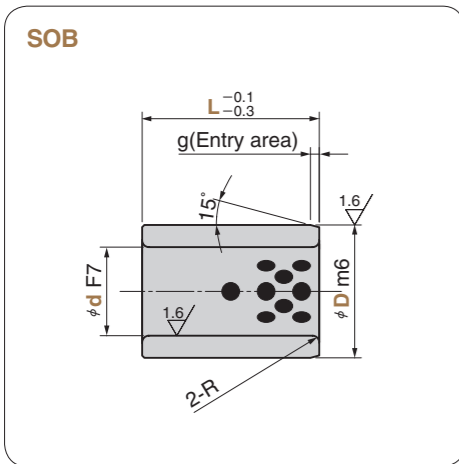

Order **Catalog No.** SOB **d** - **D** - **L**  
 SOB 30 - 40 - 60

d F7	D m6	R	g	Applicable Washer	Catalog No.	d	D	L
								12
		1						15
								16
								20
	33						33	25
		2						30
								35
								40
								50
25				SOBW25		25		60
								12
		1						15
								16
								20
	35						35	25
		2						30
								35
								40
								50
28	+0.041 +0.020				SOB	28	38	20
		1	2					25
		2						30
								40
								12
		1						15
	38							20
							38	25
								30
		2						35
								40
								50
30				SOBW30		30		60
								12
		1						15
								20
								25
	40						40	30
		2						35
								40
								50
								60

d F7	D m6	R	g	Applicable Washer	Catalog No.	d	D	L
								15
32						32	42	20
		1						30
		2						40
								20
								25
								30
	44						44	35
		2						40
								50
35				SOBW35		35		60
		1						20
								25
								30
								35
	45	+0.025 +0.009					45	40
		2						50
								60
38						38	48	30
								40
		1						15
								20
								25
								30
								35
	50						50	40
		2			SOB			50
40	+0.050 +0.025		2	SOBW40		40		60
								70
								80
		1						15
								25
								30
							55	35
								40
								50
								60
								30
							55	35
								40
								50
								60
								30
								35
								40
45				SOBW45		45	56	40
								50
								60
								30
								35
								40
	60						60	50
								60
								70
								80

# Oilless Bush

Bronze Straight Type

SO#50SP2

RoHS

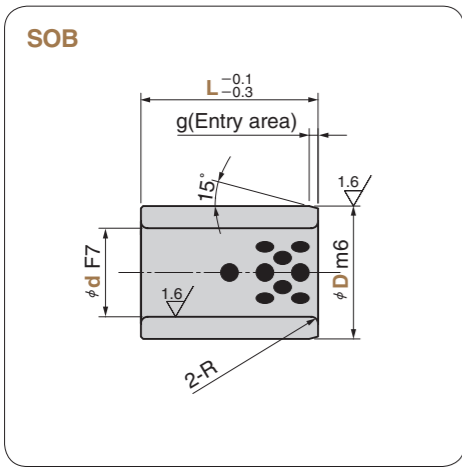

Order **Catalog No.** SOB **d** 70 - **D** 85 - **L** 100

d F7	D m6	R	g	Applicable Washer	Catalog No.	d	D	L
		1						20
		2	2					30
	60						60	35
								40
		3	3					50
								60
								70
								80
								30
50		2	2	SOBW50		50	62	35
	62							40
		3	3					50
								60
								70
								30
		2	2					40
								50
	65						65	60
		3	3					70
								80
								100
					SOB			30
		2	2					35
55				SOBW55		55	70	40
	70							50
		3	3					60
								70
								30
		2	2					35
								40
								50
	74						74	60
		3	3					70
								80
								100
60				SOBW60		60		30
		2	2					35
								40
								50
	75						75	60
		3	3					70
								80
								100

d F7	D m6	R	g	Applicable Washer	Catalog No.	d	D	L
63	75		3	3	—	63	75	60
								70
								80
			2	2				40
								50
65	80		3	3	SOBW65	65	80	60
								70
								80
								30
			2	2				35
								40
								50
	85						85	60
								70
70					SOBW70	70		80
								100
								50
							90	60
								70
			3	3				80
	90							50
								60
								70
							90	80
75					SOBW75	75		100
								60
								70
	95						95	80
					SOB			100
			1	2				20
			2					40
								50
								60
								70
			3	3			96	80
								100
								120
80			2	2	SOBW80	80		40
								50
								60
								70
							100	80
	100		3	3				100
								120
								140
			2	2				25
85			3	3	—	85	100	60
								80
								30
								50
								60
								70
90	110		3	3	SOBW90	90	110	80
								90
								100
								120

# Oilless Bush

Bronze Straight Type

SO#50SP2

RoHS

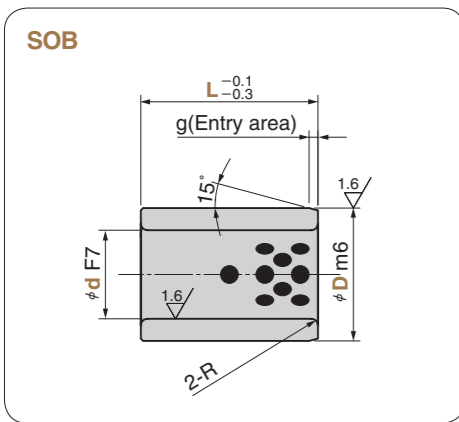

Order **Catalog No.** SOB **d** - **D** - **L**  
SOB 120 - 140 - 80

⚠ d=150 and 160 is production on request.

d F7	D m6	R	g	Applicable Washer	Catalog No.	d	D	L
		2	2					40
								50
								60
								70
100	120			SOBW100		100	120	80
								90
								100
								120
								140
								50
								70
110	130			—		110	130	80
								100
								120
			3					70
								80
120	140	3		SOBW120	SOB	120	140	90
								100
								120
								140
125	145					125	145	100
								120
130	150					130	150	100
								130
140	160			—		140	160	100
								140
								80
150	170					150	170	100
			4					150
								80
160	180		3			160	180	100
								150

■ Operation Range (SO#50SP2)

Lubricant Type	Lubricating Condition	Environment Condition	Max. Allowable Load P N/mm <sup>2</sup>	Max. Allowable Sliding Speed V m/min	Max. Allowable PV value N/mm <sup>2</sup> ·m/min	Operation Range Temperature °C
GR-1	No lubrication	Atmosphere	100	15	150	-50~+300
	Regular lubrication(Grease)			30	200	-50~+150

■ Physical Properties (SO#50SP2)

Specific Gravity g/cm <sup>3</sup>	Hardness HB	Elongation %	Tensile Strength N/mm <sup>2</sup>	Linear Expansion Coefficient ×10 <sup>-5</sup> /°C
7.9	210 or more	12 or more	755 or more	1.9

# Oilless Bush

Bronze Straight·Thin I.D. F7· O.D. m6 Type

SO#50SP2

RoHS

**SOBU**

● Sliding Direction

● Mating Post Tolerance  
d8:General use(high load)  
e7:General use(light load)  
f8:High precision

● Other Operating Conditions and Characteristics  
· Can be used in the atmosphere and fresh water (on condition).  
· Good performance in operation under high load and at low speed.

⚠ Operation temperature is 150°C or less

Material Base Bronze with Graphite(SP2)  
Solid lubricant(GR-1)

Order **Catalog No.** SOBU **d** - **D** - **L**  
SOBU 10 - 12 - 15

d F7	D m6	Housing		Thickness T	Catalog No.	d	D	L
		I.D.	H7					
6	8	8	8			6	8	8
								10
								12
8	10	10	10	1		8	10	15
								12
								15
10	12	12	12			10	12	20
								15
								20
12	15	15	15			12	15	25
								30
								30
13	16	16	16	1.5	SOBU	13	16	10
								12
								15
15	18	18	18			15	18	20
								25
								30
16	20	20	20	2		16	20	10
								15
								20
18	22	22	22			18	22	12
								15
								20