

TWP
(Bronze Standard Type)
TWPC
(Bronze Standard Type
4-C chamfering Type)

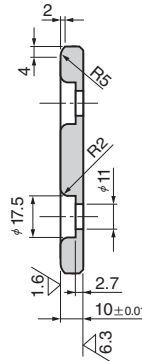

TWPT
(Bronze Standard, 2-Hole Type)
TWPTC
(Bronze Standard, 2-Hole Type
4-C chamfering Type)

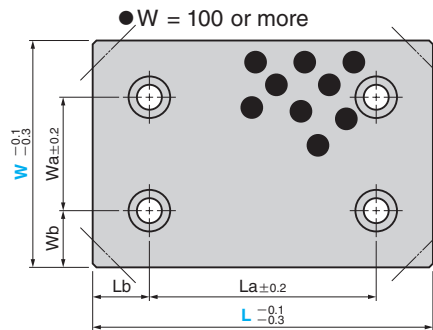
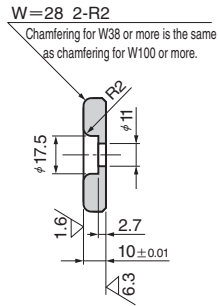
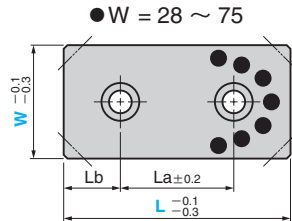
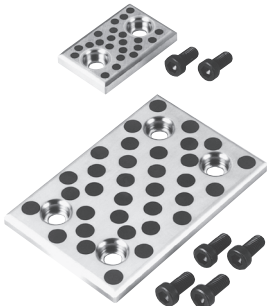
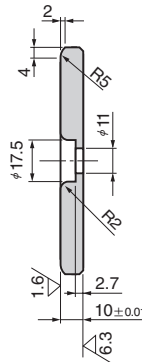
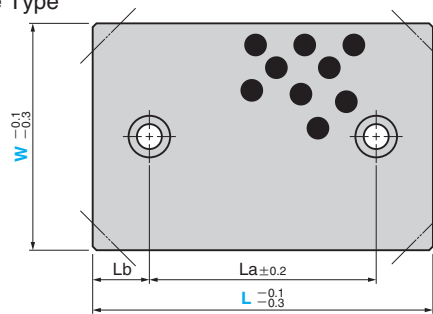
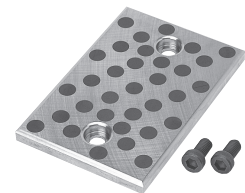

● Sliding Direction
W = 28 and 38

W = 48 or more

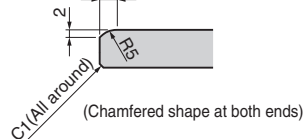

Material : Bronze with Graphite (SO#50 SP2)
Accessory : Mounting bolt

Wa	Wb	La	Lb	Catalog No.	W	L
		45	15			75
		50			28	100
		75	25			125
		100				150
		45	15			75
		50			38	100
		75	25			125
		100				150
		45	15	TWP		75
		50		TWPC		100
		75	25		48	125
		100				150
		150				200
		25				75
		50			75	125
		75				150
		100				200
		150				250
		50	25			100
		75				125
	25	100			100	150
		150		TWP		200
		200		TWPC		250
		100		TWPT		150
	37.5	150		TWPTC	125	200
		200				250
		100				150
100	25	150			150	200

Order

Catalog No.	W	-	L
TWP	75	-	150
TWPC	48	-	100
TWPT	100	-	200

● Special brazier head bolt (LCS standard)
LCS-10-20

● TWPC/TWPTC Details of 4-C chamfering

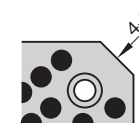
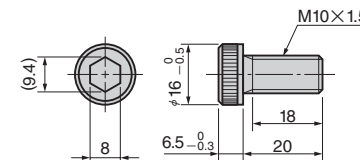

W	Size of chamfering
28	10
38	13
48	
75	
100	17
125	
150	

■ We are ready to accept requests or orders for special parts.