

- SGLS** (Steel without Dowel Hole)
- SGLSN** (Steel with Dowel Hole)
- SGLW** (Copper Alloy without Dowel Hole)
- SGLWN** (Copper Alloy with Dowel Hole)

• **L=60**

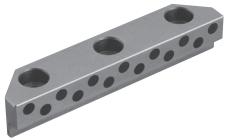

• **L=80~100**

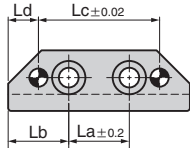
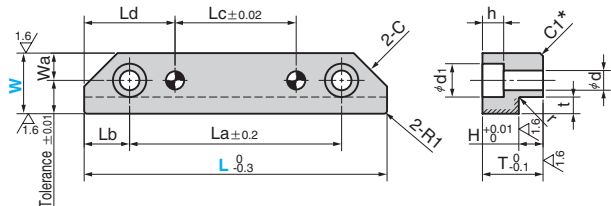

*The copper alloy type is C2.

• **L=120**

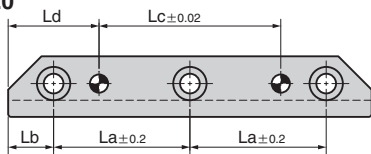

■ **Type without Dowel Hole**

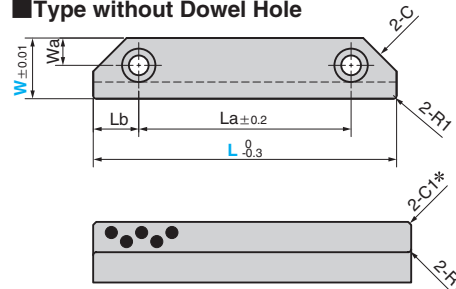

*The copper alloy type is C2.

■ **Type with dowel hole and dowel hole specification**

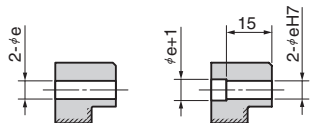

*SGLSN
SGLWN15

*SGLWN20 or more

SGLS
SGLSN
Material : SKS3
Hatched Area with Graphite and to be Induction Hardened HRC53~58

SGLW
SGLWN
Copper alloy(SP2)
Hatched Area with Graphite

W	L	Wa	La	Lb	Lc	Ld	C	T	H	t	r	d	d1	h
15	60		20	20	40	10								
	80	6	55	12.5	35	22.5	9	15	8	4.5	0.5	5.5	9.5	6
	100		75		55									
20	60		20	20	40	10								
	80	9	50		20									
	100		70	15	40	30	11	20	8	5.5	0.5	6.5	11	7
	120		45		60									
25	80		45		20									
	100	9	65	17.5	40									
	120		42.5		60	30	13	25	10	7.5	0.8	9	14	9
30	140		52.5		80									
	120		40		40									
	140	11	50	20	60	40	16	30	15	11	0.8	11	18	11
	160		60		80									
	180		70		100									

Catalog No.	W	L
	15	60
		80
		100
		60
	20	80
		100
SGLS		120
SGLSN		80
SGLW		100
SGLWN	25	100
		120
		140
		120
	30	140
		160
		180

W	e	H7
15		+0.012
20	6	0
25		+0.015
30	8	0



Order

Catalog No. **SGLSN** W **25** - L **120**