

## 9834 (DIN9834)

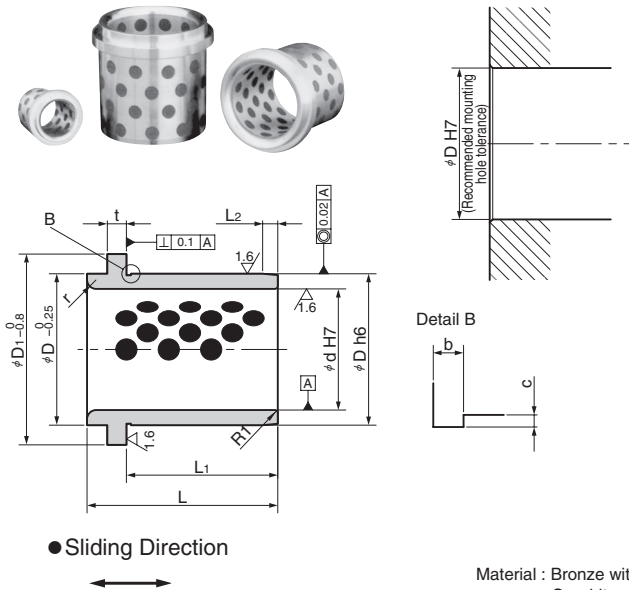

● Sliding Direction  
↔

Material : Bronze with Graphite (SO#50 SP2)

## ■ Clamp VDI-KL (DIN9832)

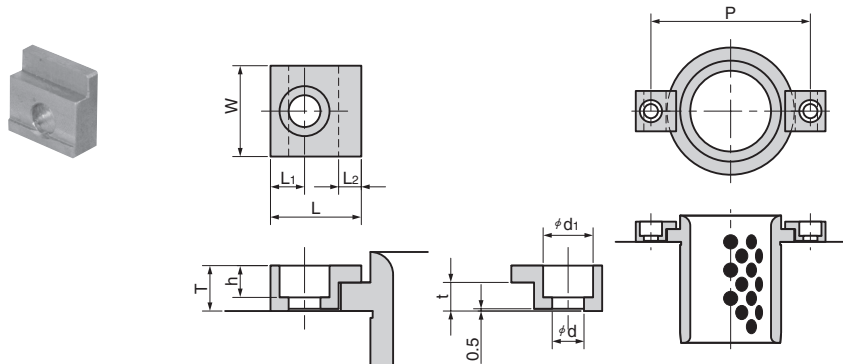

Material : ST37K(Equivalent to SS400)

Catalog No.(Type)	d	H7	D	h6	L	D <sub>1</sub>	L <sub>1</sub>	L <sub>2</sub>	t	r	b×c
9834-025 (11)	25	+0.021 0	32		40	40	30	3			
9834-032 (12)	32		40	0 -0.016	50	50	40	4	6.3	3	0.6×0.3
9834-040 (13)	40	+0.025 0	50		63	63	50	5			
9834-050 (14)	50		63	0 -0.019	71	71	56	6.3		5	
9834-063 (15)	63		80		80	90	63	8		6	
9834-080 (16)	80	+0.030 0	100	0 -0.022	100	112	80	10		8	
9834-100 (17)	100		125		125	140	106	12.5	10	10	1.0×0.4
9834-125 (18)	125	+0.040 0	160	0 -0.025	160	180	132	16		12	
9834-160 (20)	160		200	0 -0.029	200	220	170	16		18	



Order

Catalog No.

9834-063

### ■ Operating conditions

Allowable maximum surface pressure P (daN/cm <sup>2</sup> )	Allowable maximum speed V (m/min)	Allowable maximum PV value (daN/cm <sup>2</sup> ·m/min)	Operating temperature °C
1000	15	2000	-150~300

- Mating material condition  
Hardness : min HRC35  
Surface roughness :  
Ra 0.8 μm or less

### ■ Clamp

Catalog No.(Type)	W	L	T	L <sub>1</sub>	L <sub>2</sub>	t	d	d <sub>1</sub>	h	Applicable post diameter
VDI-KL- 6 ( 6)	20	20	10	7.5	5	6.3	7	11	7	φ25~φ50
VDI-KL-10 (10)	32	32	16	11	10	10	11.5	17.5	11.5	φ63~φ160



Order

Catalog No.

VDI-KL-10

### ● Clamp mounting hole circle

Bushing Hole Diameter	P
25	58
32	66
40	79
50	89
63	123
80	143
100	168
125	203
160	243