

# Guide Pin

FLANGE TYPE

RoHS

RGPA

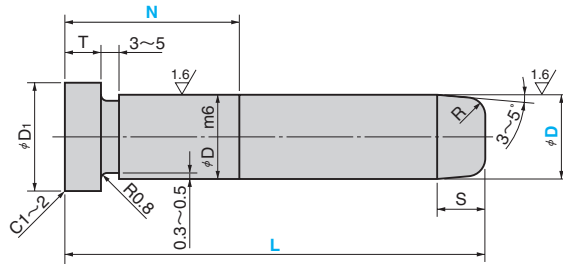

Material : SUJ2  
 (B1 A 52100)  
 Hardness : HRC58 or more  
 Induction Hardened

D	D m6	T	D1	S	Catalog No.	D	L (Increments of 5mm)	Press fit area N (Increments of 1mm)
20	20	8	25	5	RGPA	20	75~200	8~100
25	25		30			25	105~300	8~120
30	30		35			30	130~350	8~130
35	35	10	40	8	RGPA	35	155~400	8~130
40	40		45			40	155~450	10~200
50	50		55			50	155~450	12~200

Order **Catalog No.** **D** - **L** - **N**  
 RGPA 25 - 200 - 50

# Guide Pin

STRAIGHT TYPE(TAPPED)

RoHS

RGPL

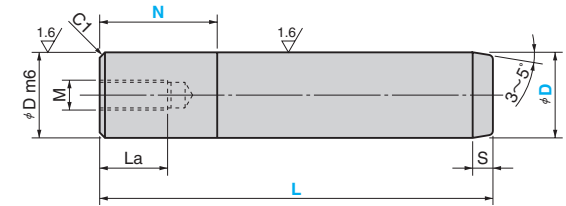

Material : SUJ2  
 (B1 A 52100)  
 Hardness : HRC58 or more  
 Induction Hardened

D	D m6	M×Pitch	La	S	Catalog No.	D	L (Increments of 5mm)	Press fit area N (Increments of 1mm)
20	20	M8×P1.25	16	5	RGPL	20	75~225	0~100
25	25					25	75~275	0~100
30	30					24	30	105~300
35	35	M16×P2.0	32	8	RGPL	35	105~300	0~120
40	40					40	105~325	0~140
50	50					50	130~400	0~140
60	60	M20×P2.5	40		RGPL	60	180~400	0~200
80	80					80	180~400	0~200

Order **Catalog No.** **D** - **L** - **N**  
 RGPL 30 - 200 - 50

Option

Option Code	Specification						
HMC	Tapped hole for lifting is drilled at the end. Applicable to D60 and 80. <table border="1"> <tr> <th>D</th> <th>Thread diameter (M) x Depth</th> </tr> <tr> <td>60・80</td> <td>M16×32</td> </tr> </table>	D	Thread diameter (M) x Depth	60・80	M16×32		
D	Thread diameter (M) x Depth						
60・80	M16×32						
GM	Tapped hole for Assist Pin mounting is drilled at the end. Applicable to D60 and 80. <table border="1"> <tr> <th>D</th> <th>Thread diameter (M) x Depth</th> </tr> <tr> <td>60</td> <td>M30×35</td> </tr> <tr> <td>80</td> <td>M36×45</td> </tr> </table>	D	Thread diameter (M) x Depth	60	M30×35	80	M36×45
D	Thread diameter (M) x Depth						
60	M30×35						
80	M36×45						

Refer to page. 20 for the assist pin details.



•GM specification

D	d
60	36
80	41

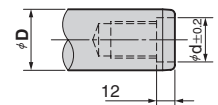

Order **RGPL 60 - 300 - 75 - GM**