

VDI (ST01)  
VDI (ST02)

● Form A

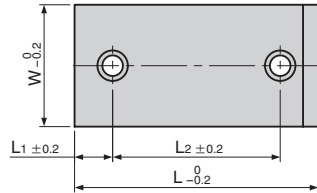

● Form B

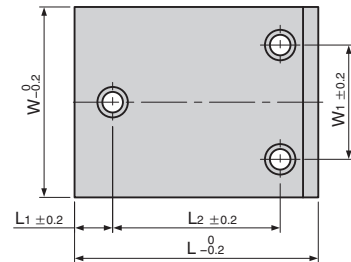

● Form C

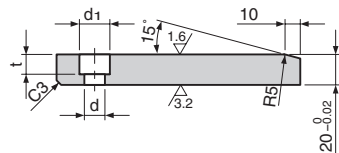
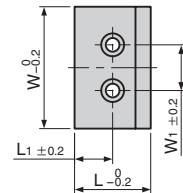

VDI(ST01) Material : 1.2312  
DIN 40Cr MnMo88.6  
(SCM440)  
VDI(ST02) Material : 1.2379  
DIN X55CrVMo12.1  
(SKD11)  
Hardness : HRC58~60



| Catalog No.     |                 | W   | L   | L1 | L2  | W1  | Form | d    | d1 | t  | Recommended mounting bolt |
|-----------------|-----------------|-----|-----|----|-----|-----|------|------|----|----|---------------------------|
| Steel "01" Type | Steel "02" Type |     |     |    |     |     |      |      |    |    |                           |
| VDI-62-ST01     | VDI-62-ST02     |     | 80  |    | 30  |     |      | 9    | 15 | 9  | M8x25                     |
| VDI-63-ST01     | VDI-63-ST02     |     | 100 |    | 50  |     |      |      |    |    |                           |
| VDI-64-ST01     | VDI-64-ST02     | 50  | 125 |    | 75  | —   | A    | 13.5 | 20 | 13 | M12x25                    |
| VDI-65-ST01     | VDI-65-ST02     |     | 160 |    | 110 |     |      |      |    |    |                           |
| VDI-66-ST01     | VDI-66-ST02     |     | 200 |    | 150 |     |      |      |    |    |                           |
| VDI-71-ST01     | VDI-71-ST02     |     | 50  | 25 | —   | 30  | C    | 9    | 15 | 9  | M8x25                     |
| VDI-72-ST01     | VDI-72-ST02     |     | 80  |    | 30  |     |      |      |    |    |                           |
| VDI-73-ST01     | VDI-73-ST02     |     | 100 |    | 50  |     |      |      |    |    |                           |
| VDI-74-ST01     | VDI-74-ST02     |     | 125 |    | 75  | —   | A    | 13.5 | 20 | 13 | M12x25                    |
| VDI-75-ST01     | VDI-75-ST02     |     | 160 |    | 110 |     |      |      |    |    |                           |
| VDI-76-ST01     | VDI-76-ST02     |     | 200 |    | 150 |     |      |      |    |    |                           |
| VDI-81-ST01     | VDI-81-ST02     |     | 50  | 25 | —   | 50  | C    |      |    |    |                           |
| VDI-82-ST01     | VDI-82-ST02     |     | 80  | 40 | —   | 50  | C    |      |    |    |                           |
| VDI-83-ST01     | VDI-83-ST02     |     | 100 |    | 50  |     |      | 13.5 | 20 | 13 | M12x25                    |
| VDI-84-ST01     | VDI-84-ST02     | 100 | 125 |    | 75  | —   | A    |      |    |    |                           |
| VDI-85-ST01     | VDI-85-ST02     |     | 160 | 25 | 110 |     |      |      |    |    |                           |
| VDI-86-ST01     | VDI-86-ST02     |     | 200 |    | 150 |     |      |      |    |    |                           |
| VDI-91-ST01     | VDI-91-ST02     |     | 50  | 25 | —   |     | C    |      |    |    |                           |
| VDI-92-ST01     | VDI-92-ST02     |     | 80  | 40 | —   |     |      |      |    |    |                           |
| VDI-93-ST01     | VDI-93-ST02     |     | 100 |    | 50  |     |      | 13.5 | 20 | 13 | M12x25                    |
| VDI-94-ST01     | VDI-94-ST02     | 125 | 125 |    | 75  | 75  | B    |      |    |    |                           |
| VDI-95-ST01     | VDI-95-ST02     |     | 160 | 25 | 110 |     |      |      |    |    |                           |
| VDI-96-ST01     | VDI-96-ST02     |     | 200 |    | 150 |     |      |      |    |    |                           |
| VDI-101-ST01    | VDI-101-ST02    |     | 50  | 25 | —   |     | C    |      |    |    |                           |
| VDI-102-ST01    | VDI-102-ST02    |     | 80  | 40 | —   |     |      |      |    |    |                           |
| VDI-103-ST01    | VDI-103-ST02    |     | 100 |    | 50  |     |      | 13.5 | 20 | 13 | M12x25                    |
| VDI-104-ST01    | VDI-104-ST02    | 160 | 125 |    | 75  | 110 | B    |      |    |    |                           |
| VDI-105-ST01    | VDI-105-ST02    |     | 160 |    | 110 |     |      |      |    |    |                           |
| VDI-106-ST01    | VDI-106-ST02    |     | 200 |    | 150 |     |      |      |    |    |                           |



Order

Catalog No.  
VDI-85-ST01