

GP DIN 9833

● D = φ25 ~ φ63

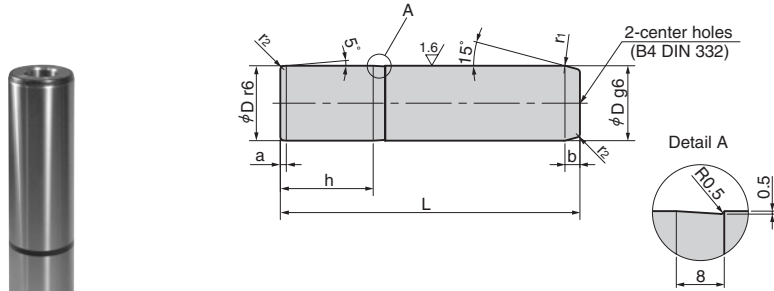

● D = φ80 ~ φ160

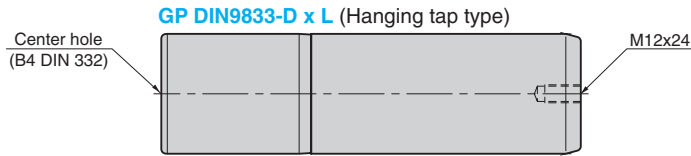

GP DIN9833-D x L (Hanging tap type)

▲ Freeze the press fit area (Dr6) to -80°C for fitting.

GP DIN9833-D x L-H (Hollow type)



Solid type Material : 42CrMo4V (SCM440) Hardness : HRC60~64 (Depth 1.5~2.0mm)
 Hollow type Material : 1.3536 (S53C) Hardness : HRC60~64 (Depth 1.5~2.0mm)

D	Tolerance		h	a	b	r1	r2	d
	g6	r6						
25	-0.007 -0.020	+0.041 +0.028	40					
32			45		8	3	2	
40	-0.009 -0.025	+0.050 +0.034	56					-
50			70	4		5	2.5	
63	-0.010 -0.029	+0.060 +0.041	80		10	6		
80		+0.063 +0.043	100			8	3	40
100	-0.012 -0.034	+0.073 +0.051	125			10		50
125		+0.068 +0.063	140			12	4	65
160	-0.014 -0.039	+0.090 +0.065	180	5	12	18		95

Catalog No.	D	L
		125
	25	140
		160
		180
		200
	32	140
		160
		180
		200
		224
		250
		280
		315
		355
		400
		450
		500
		560
GP(GUIDE POST) DIN9833	40	200
		224
		250
		280
		315
		355
		400
		450
		500
		560

Catalog No.	D	L
		180
		200
		224
	63	250
		280
		315
		355
		400
		450
		500
		560
GP(GUIDE POST) DIN9833	80	315
		355
		400
		450
		500
		560
	100	315
		355
		400
		450
		500
		560
	125	400
		450
		500
		560
	160	400
		450
		500
		560



Order

Catalog No. - D X L

GP DIN9833 - 50 X 250

GP DIN9833 - 80 X 280

GP DIN9833 - 80 X 400

(Hanging tap type)

- H (Hollow type)