

# Shaft

FOR BELL CRANK LIFTER UNIT

SBSHA

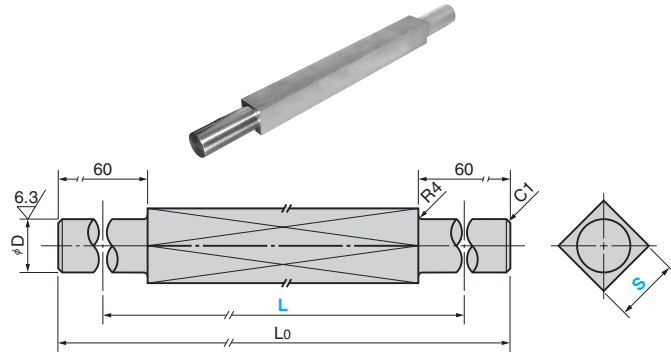

SBSHB

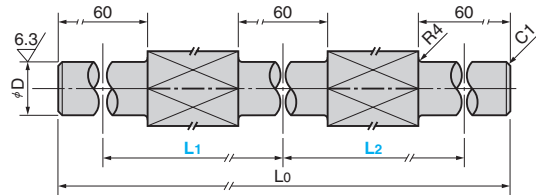

SBSHC

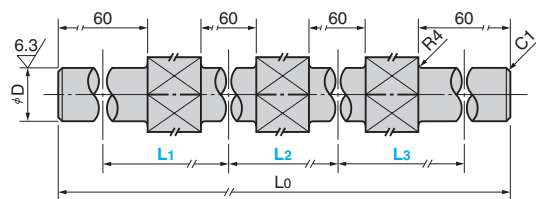

\* L, L<sub>1</sub>, L<sub>2</sub> and L<sub>3</sub> are dimensions between centers at φD.  
\* L<sub>0</sub> is the overall length.

Material: SS400

S Tolerance	D Tolerance	Catalog No.	S	L, L <sub>1</sub> , L <sub>2</sub> , L <sub>3</sub>	Range for L <sub>0</sub> size
28	25	<b>SBSHA</b>	<b>28</b>	Determine the size within the range in the right. (Increment of 1 mm)	SBSHA L <sub>0</sub> ≤ 1600
38	35	<b>SBSHB</b>	<b>38</b>		SBSHB L <sub>0</sub> ≤ 2000
50	45	<b>SBSHC</b>	<b>50</b>		SBSHC L <sub>0</sub> ≤ 2000

Order **Catalog No.** **S** - **L** - **L<sub>1</sub>** - **L<sub>2</sub>** - **L<sub>3</sub>**

**SBSHA** 28 - 980

**SBSHB** 28 - 500 - 600

**SBSHC** 28 - 400 - 400 - 400

▲ SBSHA, SBSHB and SBSHC are made to order.

# Arm Block

FOR BELL CRANK LIFTER UNIT

SBABC

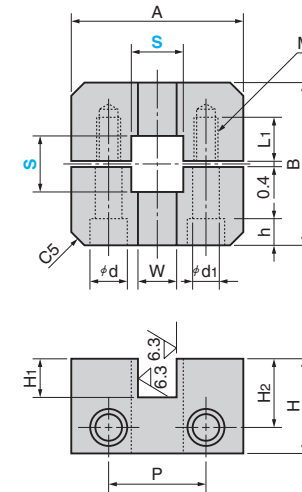
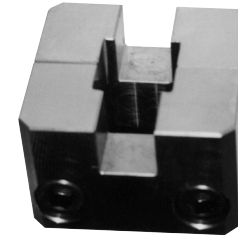

Material: SS400

Catalog No.	S Tolerance	A	B	W Tolerance	d	d <sub>1</sub>	h	M	L <sub>1</sub>	H	H <sub>1</sub>	H <sub>2</sub>	P		
<b>SBABC</b>	28	+0.013 0	75	70	20	+0.052 0	20	13	13	12	25	50	20	35	50
	38	+0.016 0	90	80	30				30	55	25	40	65		
	50		110	100	40	+0.062 0	26	18	18	16	35		80		

Order **Catalog No.** **S**

**SBABC** **38**

▲ Made to order.