

Panel Stabilizer Pin

SPRING TYPE

CAD FILE

PSPSN (Stabilizer Pin end Steel Type-No machining)
PSPSS (Stabilizer Pin end Steel Type-Spherical machining)
PSPSU (Stabilizer Pin end Urethane Type)



*Spring Load

Travel S	Spring Load(N)	
	Initial Load	Final Load
200	10.0	67.0
220	10.0	67.0
250	8.5	67.0
270	8.7	67.0
300	6.3	67.0

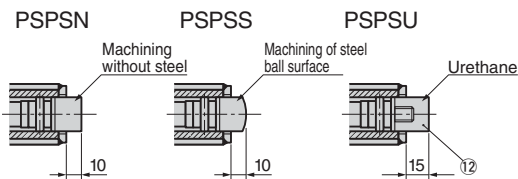
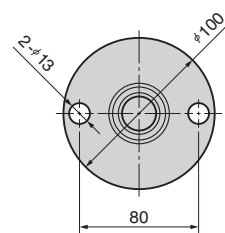
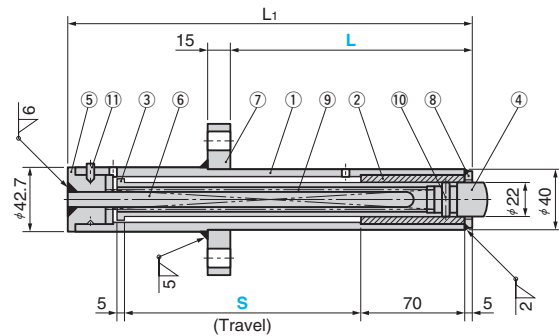

■ Cut option of flange

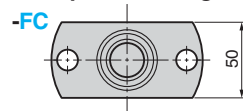

■ Table of Components

No.	Description	Qty	Material and Remark	No.	Description	Qty	Material and Remark
①	Holder	1	STPA-22	⑦	Flange	1	SS400
②	Guide Bushing	1	Bronze(SP2)	⑧	Washer	1	SS400
③	Slide Pin	1	STPA-22	⑨	Spring	1	SWPA CS-A-14×1.6
④	Advance Pin	1	S45C	⑩	Spring Pin	1	SK5M #5×22
⑤	Stopper Pin	1	SS400	⑪	Hexagonal Socket Screw Set	2	SCM435 M6×10
⑥	Spring Guide Pin	1	S45C-D	⑫	Advance Pin(end)	(1) Urethane	

L1	Catalog No.	Travel S	L Increments of 1mm
312	PSPSN PSPSS PSPSU	200	90~260
338		220	90~280
364		250	90~310
390		270	90~340
414		300	90~360

Order Option Catalog No. S - L
PSPSU 200 - 150



Option Code	Specification
FC	Flange is cut to 50 mm. (Refer to the drawing.)



Order **PSPSN 250 - 200 - FC**

Panel Stabilizer Pin

GRAVITY TYPE

CAD FILE

PSPWN (Stabilizer Pin end Steel Type-No machining)
PSPWS (Stabilizer Pin end Steel Type-Spherical machining)
PSPWU (Stabilizer Pin end Urethane Type)



*Advanced Pin Weight

Travel S	Advanced Pin Weight (g)
200	1,050
220	1,130
250	1,250
270	1,320
300	1,440

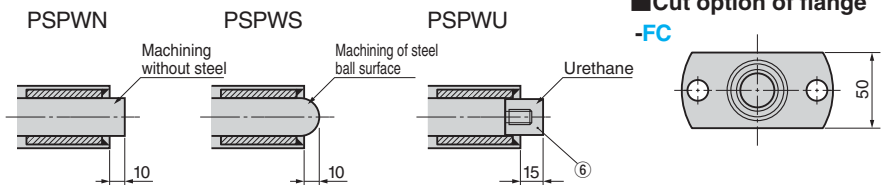
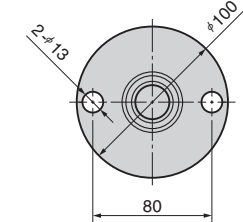
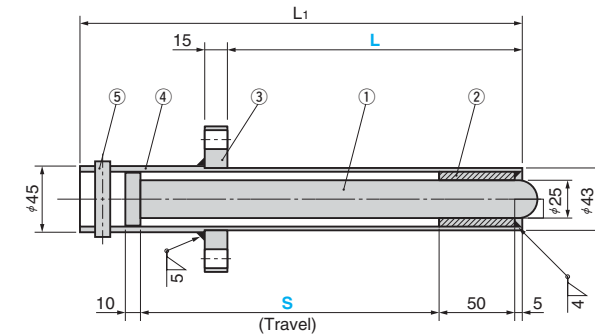

■ Cut option of flange

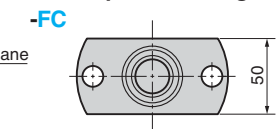

■ Table of Components

No.	Description	Qty	Material and Remark
①	Advance Pin	1	S45C HRC55~60
②	Guide Bushing	1	SS400
③	Flange	1	SS400
④	Holder	1	STPA
⑤	Spring Pin	2	SK5M #10×50
⑥	Advance Pin(end)	(1) Urethane	

L1	Catalog No.	Travel S	L Increments of 1mm
295	PSPWN PSPWS PSPWU	200	10~250
315		220	10~270
345		250	10~300
365		270	10~320
395		300	10~350

Order Option Catalog No. S - L
PSPWS 250 - 200



Option Code	Specification
FC	Flange is cut to 50 mm. (Refer to the drawing.)



Order **PSPWN 250 - 200 - FC**