

### TWP (Bronze Standard Type)

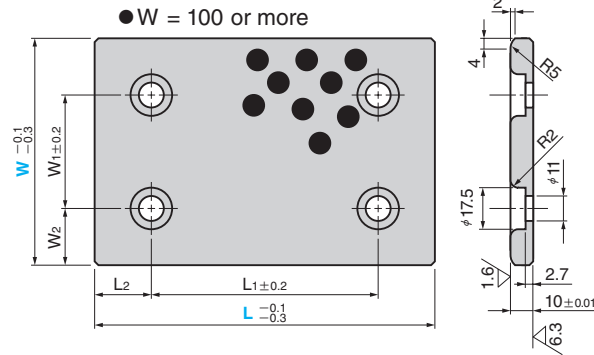

### TWPT (Bronze 2-Hole Type)

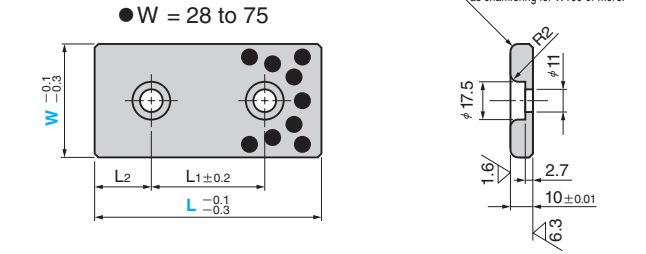
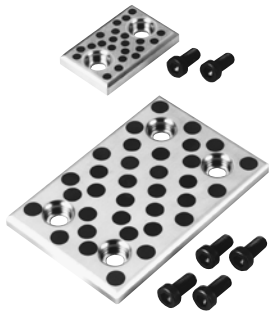
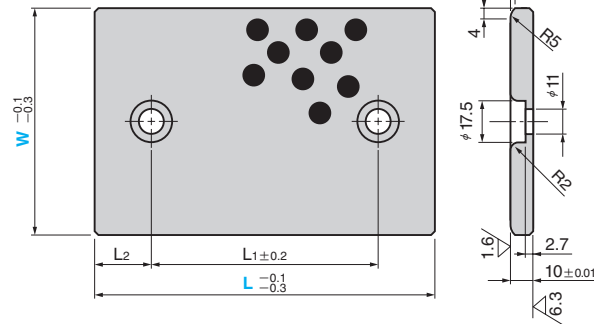
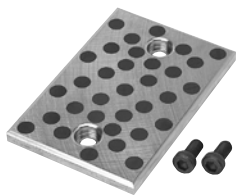

● Sliding Direction  
W = 28 and 38

W = 48 or more

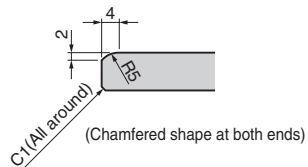

Material : Bronze with Graphite (SO#50 SP2)  
Accessory : Mounting bolt

W1	W2	L1	L2	Catalog No.	W	L
		45	15			75
		50			28	100
		75	25			125
		100				150
		45	15			75
		50			38	100
		75	25			125
		100				150
		45	15			75
		50			TWP	100
		75	25			125
		100				150
		45	15			75
		50			48	100
		75	25			125
		100				150
		150				200
		45	15			75
		50			58	100
		75	25			125
		100				150
		150				200
		45	15			75
		50			75	100
		75	25			125
		100				150
		150				200
		50				100
		75	25			125
	25	100			100	150
		150				200
		200				250
50		100			TWP TWPT	150
		200				250
	37.5	150			125	200
		200				250
		250				300
		100			150	150
100	25	150				200

\* W1 and W2 are the dimensions only for SESF (W = 100 or more).



Order

Catalog No.	W	L
TWP	75	150
TWPT	100	200

● Special brazier head bolt  
(LCS standard)  
LCS10-20

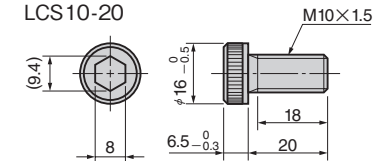

■ We are ready to accept requests or orders for special parts.