

SOX (Sintered and Standard Type) ● W = 28 to 75

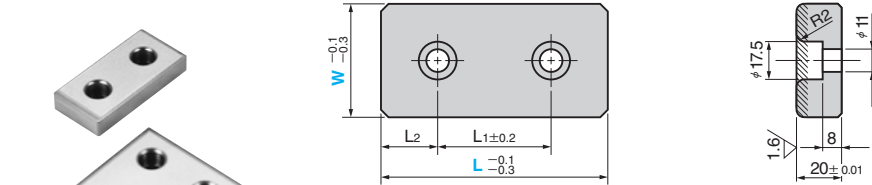

● W = 100 or more

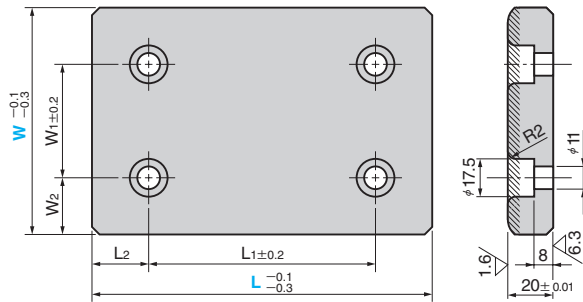

SOXT (Sintered 2-Hole Type)

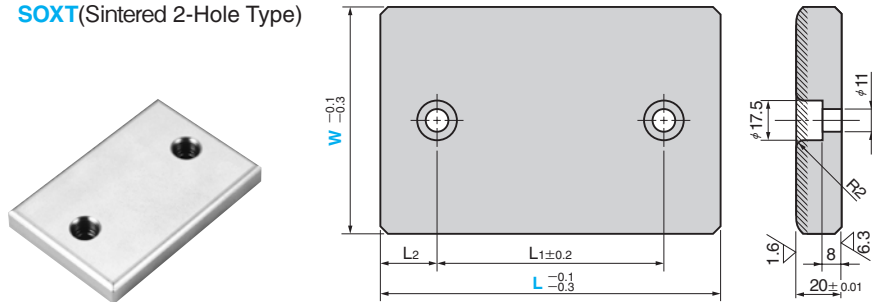

● Sliding Direction



Please refer page 182 about the chamfer.

Material : Copper powder sintered (#200)
 Hatched Area Sintered
 Thickness 1.2 mm or more
 SS400(base plate)

W ₁	W ₂	L ₁	L ₂	Catalog No.	W	L	
						SOX	SOXT
		45	15			75	
		50	25		28	100	
		100	25			150	
		45	15			75	
		50	25		38	100	
		100	25			150	
		45	15			75	
		50	25			100	
		75	25		48	125	
-	-	100	50	SOX		150	-
						200	
		45	15			75	
		50			58	100	
		100				150	
		25				75	
		50				100	
		75			75	125	
		100	25			150	
		150	25			200	
		50				100	100
		75				125	125
50	25	100			100	150	150
		150				200	200
		200	50			250	250
						300	-
		75		SOX		125	-
		100	25	SOXT		150	150
50	37.5	150			125	200	200
		200	50			250	250
						300	-
		100				150	150
100	25	150	25		150	200	200
		200				250	250

* W₁ and W₂ are the dimensions only for SESF (W = 100 or more).



Order

Catalog No.	W	-	L
SOX	48	-	75
SOXT	125	-	150

■ We are ready to accept requests or orders for special parts.