

PGBAK (Dowel Pin Hole Finished • FC Type)
PGBSK (Dowel Pin Hole Finished • S45C Type)

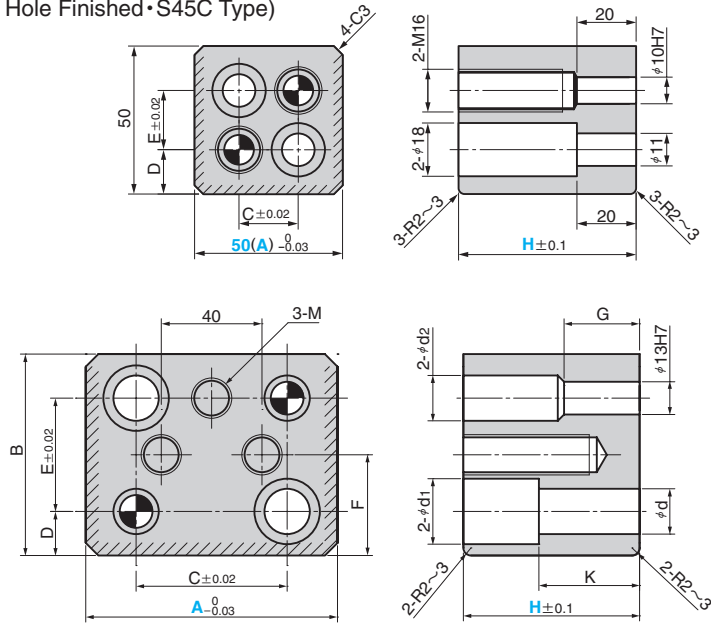
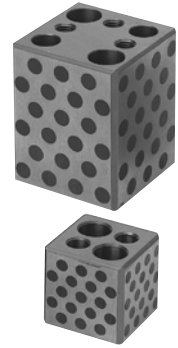

Material
 PGBAK FC250
 PGBSK S45C with Graphite (Hatched Area)

■ Keeper Plate Type

KPLT
 (Single-Surface Type)

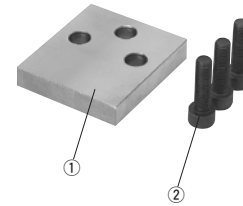

for A=50

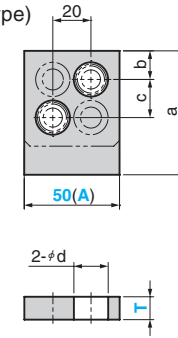

for A=70,100

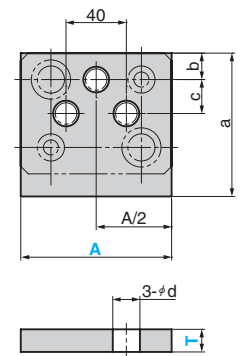

KPLTT
 (Three-Surface Type)

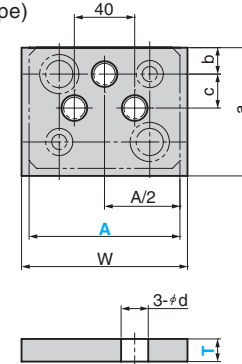

Material ①S45C
 ②SCM435

B	C	D	E	F	G	K	d	d ₁	d ₂	M	Catalog No.	A	H
50	20	15	20	-	-	-	-	-	-	-	PGBAK PGBSK	50	50 60 90
70	40	15	40	35	25	30	13	20	16	M12		70	70 90
80	60	17.5	45	40	30	40	18	26	18	M16		100	70 90 130*

d	②Attached bolt	a	b	c	Catalog No.	A	T
18	M16×50	65	15	20	KPLT	50	12
13	M12×40	85	15	20		70	15
17	M16×50	95	17.5	22.5		100	

d	②Attached bolt	W	a	b	c	Catalog No.	A	T
13	M12×40	80	75	15	20	KPLTT	70	15
18	M16×50	110	85	17.5	22.5		100	

Order - *H=130 is PGBSK only.

PGBAK 50 - 60
 PGBSK 100 - 90

Option Code	Specification
HB	Replace to Hex. Head bolt from Hex.Socket Head cap screw (②).
KP	Keeper plate (KPLT) and Hex. Socket cap screw are attached.
TKP	Keeper plate (KPLTT) and Hex. Socket cap screw are attached.

Order PGBSK 100 - 90 - TKP
 PGBAK 50 - 60 - KP - HB

Order -
 KPLT 70 - 15



Example

