

# Press Fit Ball Guide Post Set

DIE SETTING

CAD  
FILE

SAP (③ : Aluminum) SAA (③ : Aluminum, Movable Stopper) SAK (③ : Aluminum, Fixed Stopper)  
SAG (③ : Resin) SAJ (③ : Resin, Movable Stopper) SAT (③ : Resin, Fixed Stopper)

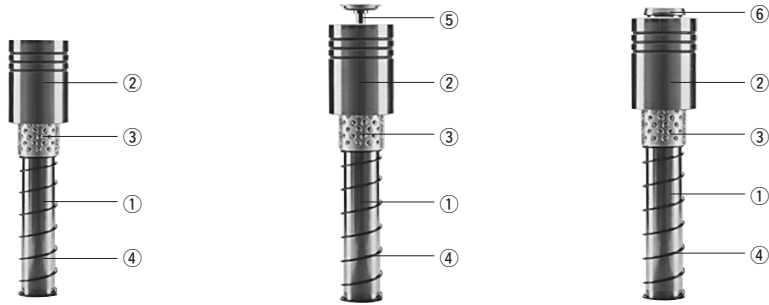

## ① : Guide Post

AGP (for SAP/SAG) AGPM (for SAA/SAJ) AGPF (for SAK/SAT)  
(Refer to page147) (Refer to page147) (Refer to page147)

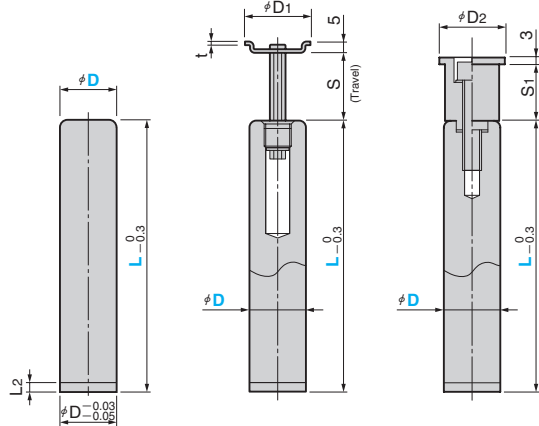

## ② : Guide Bushing

BLB  
(Refer to page151)

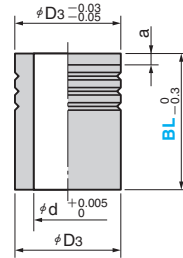

## ③ : Ball Slide

BSA (Aluminum)  
BSJ (Resin)  
(Refer to page151)

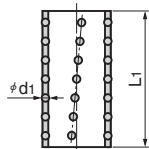

## ④ : Spring

RSS (Refer to page154)

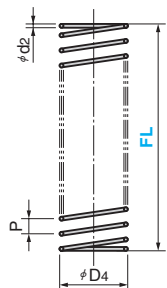

## Table of Components

No.	Description	Qty	Material and Remark
①	Guide Post	1	SUJ2 HRC58 or more (induction hardening)
②	Guide Bushing	1	SUJ2 HRC58 or more
③	Ball Slider	1	BSA: Aluminum(A5052S)
		1	BSJ: Resin(POM)
④	Spring	1	SWP2
⑤	Movable Stopper	1	SCM415 (support tray SPCC)
⑥	Fixed Stopper	1	S45C

① Guide Post							② Guide Bushing				③ Ball Slider		④ Spring		
D Tolerance	D1	S	t	D2	L2	S1	D3 Tolerance	d	a	d1	D4	d2	P		
25	+0.020 +0.015	29	23	29	4	20	45	0	31	4	3	27.9	1.2	14	
28	+0.025 +0.020	33	30	33	5	25	50	-0.007	36	5	4	31.3	1.4	16	
32		37	30	37	6	25	55	0	40			35.7	1.6		
38	+0.030 +0.025	44	37	44	6	30	64	-0.008	48			42.5	2.0	18	
50	+0.035 +0.030	56	37	56	7	30	83	0	60	6	5	55.7	2.6	20	
60		66	47	66		35	95	-0.010	70			66.9	3.2		

Catalog No.	D	L							② BLB		④ RSS		③
		120	130	140	150	160	170	180	BL	FL (Increments of 10 mm)	L1		
SAP SAG	25	120	130	140	150	160	170	180	60	40~150	60		
									80		75		
SAA SAJ	32	160	170	180	190	200	220	240	60	50~150	60		
									80		75		
SAK SAT	50	200	220	240	260				80	70~190	90		
									100		75		
	60	200	220	240	260				80	80~190	90		
									100		110		
									120		90		
									120	80~190	110		



Order

Catalog No.	D	L	BL	FL
SAP	32	180	80	140



Option

Option Code	Specification
H	The ball slider is changed to the highly rigid type.



Order

SAG-38-200-100-120-H



See page 152 for option details.