

# Height Block · Stock Block

FLAT TYPE

CAD FILE

HBH·HBHL (for Plain Oilless)  
HBF·HBFL (for Ball Guide)

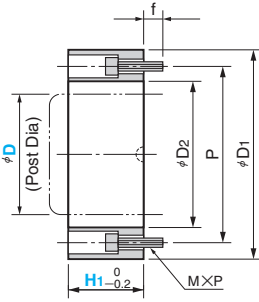
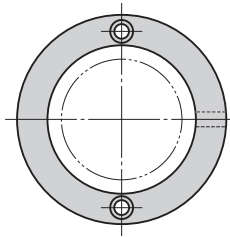

Material : SS400  
Accessories : Mounting bolt (2)

SBH (for Plain Oilless)  
SBF (for Ball Guide)

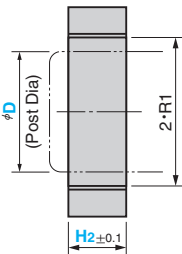
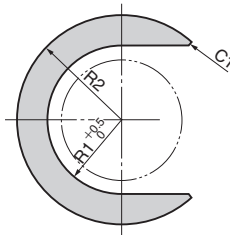

Material : SS400

D	D1	D2		P	M×P	f	R1		R2
		HBH	HBF				SBH	SBF	
25	46	29	31.5	37	M4×0.7	10	14.5	15.75	23
32	56	37	41	45			18.5	20.5	28
38	72	43	49	60			21.5	24.5	36
50	86	56	62	72	M6×1.0	12	28	31	43
60	112	66	76	92	M8×1.25		33	38	56
80	140	88	100	116	M8×1.25		44	50	70

Catalog No.	D	H1 Increments of 5 mm	Safety color
	25	10~50	
HBH	32	10~50	R (Red)
HBF	38	15~50	Y (Yellow)
	50	20~50	N (None)
	60	20~50	
	80	20~50	

Catalog No.	D	H2 Increments of 5 mm	Safety color
	25	10~40	
SBH	32	10~40	R (Red)
SBF	38	10~50	Y (Yellow)
	50	10~50	N (None)
	60	10~50	
	80	10~50	

Catalog No.	D	H1 Increments of 1 mm	Safety color
	25	11~49	
	32	11~49	R (Red)
HBHL	38	16~49	Y (Yellow)
HBFL	50	21~49	N (None)
	60	21~49	
	80	21~49	

▲ To determine H1 size, sizes that can be specified in HBH and HBF are excluded.

Order	Catalog No.	D	H1 or H2	Safety color
	HBF	38	25	R
	HBHL	38	16	N
	SBH	38	15	Y

Option See page 133 for groove machining and chain installation machining.

## Height Block Set

HBHS (for Plain Oilless, HBH + SBH)  
HBFS (for Ball Guide, HBF + SBF)



\* Mounting bolts (2) attached

Catalog No.	D	H1 Increments of 5 mm	H1 Safety color	H2 Increments of 5 mm	H2 Safety color
	25	10~50		10~40	
	32	10~50		10~40	
HBHS	38	10~50	R (Red)	10~50	R (Red)
HBFS	50	20~50	Y (Yellow)	10~50	Y (Yellow)
	60	20~50	N (None)	10~50	N (None)
	80	20~50		10~50	

Order	Catalog No.	D	H1	H1 Safety color	H2	H2 Safety color
	HBFS	50	30	R	20	Y

Option See page 133 for groove machining and chain installation machining.