

Stopper

FOR HOLDER TYPE GUIDE POST SET

MS (Movable Stopper)

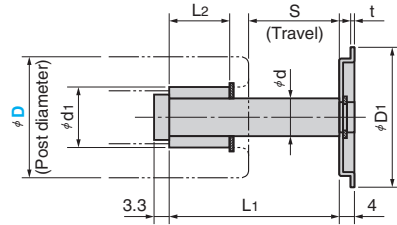

Material :
Support plate : SPCC
Uni-chrome plating
Pin : SCM415
Collar : SS400
Accessories :
C-shaped snap ring

FSN (Fixed Stopper)

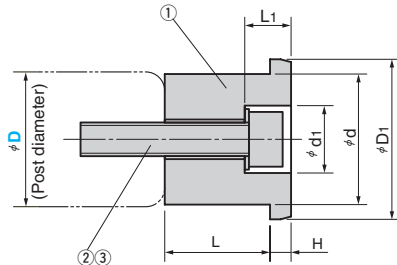

Material :
① S45C Black oxide
② SCM435
③ Spring washer

D1	L1	S	d	d1	L2	t	Ball Slider Length L	Catalog No.	D
29	36.5	0~20	6.1	12.5	12	1.0	50	MS	25
37	45.5	0~25					60		32
44	49.5	0~30	8.1	15.5	16	1.2	70		38
56	62.5	0~40					90		50

D1	d	d1	L	L1	H	② Bolt	Catalog No.	D
29	24		20		5	M10×25	FSN	25
37	31	17.5	25	15		M10×30		32
44	37		30		10	M10×40	FSN	38
56	49	20	40	20		M12×50		50
66	59		50		15	M12×65		60

Order	Catalog No.	D
	MS	32
	FSN	38

Option

FOR HOLDER TYPE GUIDE POST SET

Drilling of Center Dowel Pin Hole

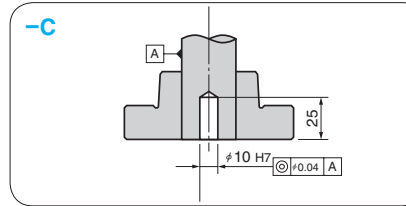

-C
Dowel pin hole for location is drilled at the center of the guide post.

Order SGO 32 - 140 - C

Drilling of Height Block Mounting Tapped Hole

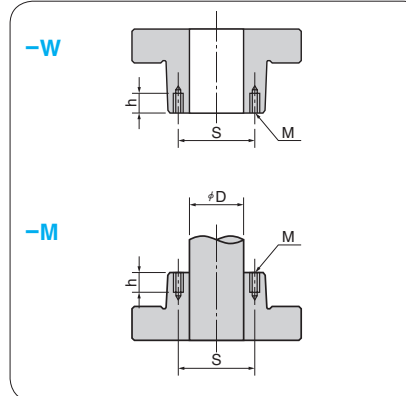

-W
Tapped hole for height block mounting is drilled on the guide bushing.
*Does not apply to Ball Guide Type.

-M
Tapped hole for height block mounting is drilled on the guide holder.
Only φ25 and φ32.

Order SGR 60 - 250 - W

D	M	h	S
25	4	12	37
32			45
38	5	15	60
50	6		72
60		20	92
80	8		116

Machining of Reverse Holder and Bushing Type

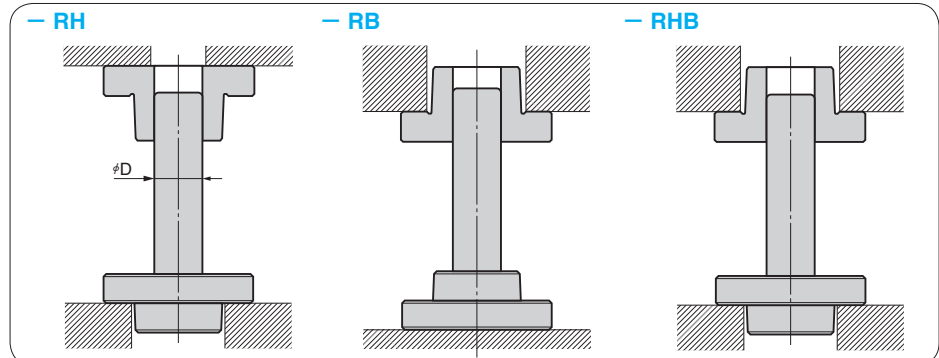

-RH
The flange surface of the guide holder is machined flat for inverted mounting type.

-RB
The flange surface of the guide bushing is machined flat for inverted mounting type.

-RHB
Both the guide holder and the guide bushing are inverted mounting type.

● Dimension that can reduce die height

D	RH	RB	
		Plain oilless	Ball guide
25	10	25	30
32	20	30	40
38	25	35	45
50	40	60	65
60	45	70	70
80	65	95	—

Order SGR 60 - 250 - RH