

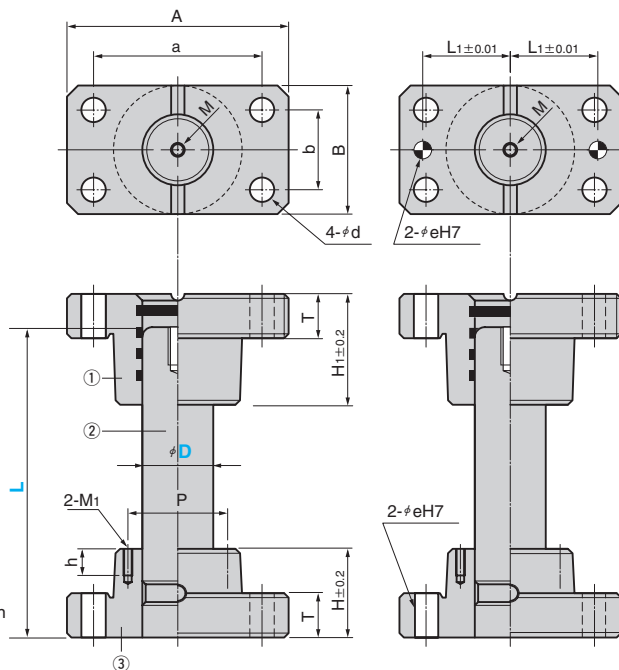

SGR
SGRL (Type for Dimension L)

With dowel pin hole
SGRN
SGRNL (Type for Dimension L)



T Tapped holes (2-M1) on Dia. φ38 and over.

Table of Components

No.	Description	Qty	Material and Remark	Catalog No.
①	Guide Bushing	1	FC250 with Graphite	SGRB, SGRBN
②	Guide Post	1	S45C induction hardened HRC55 or more	NGP
③	Guide Holder	1	FC250	GPH, GPHN
Accessories	Hexagon Socket Head Bolt	8	SCM435	
	Dowel Pin with Female Thread	4	SUJ2 Tolerance m6	

Accessories

D	Hexagon Socket Head Bolt	Dowel Pin
25	M 8×35	φ8×30
32	M10×40	
38	M10×45	φ10×40
50	M12×50	
60	M16×60	φ13×50
80	M20×75	φ16×60

D Tolerance	A	a	B	b	T	H	P	M ₁	h	H ₁	d	M	L ₁	e H7
25	+0.024 +0.015	84	66	48	30	20	30	-	-	45	9	-	33	8
32	+0.028 +0.017	100	76	58	36	25	40	-	-	50	11	-	38	10
38		130	100	75	44	50	60	M5	15	60	14	-	50	10
50	+0.033 +0.020	155	125	90	60	30	65	72	M6	85	14	-	62.5	10
60		190	150	120	80	75	92	M8	20	100	18	M12	75	13
80		230	180	150	110	35	100	116		130	22		95	16

Catalog No.	D	L																	
SGR SGRN	25	80	90	100	110	120	130	140	150	160	170	180	200						
	32	90 100 110 120 130 140 150 160 170 180 200 220 250																	
	38	100 110 120 130 140 150 160 170 180 200 220 250 280 300																	
	50	160 170 180 200 220 250 280 300 350																	
	60	180 200 220 250 280 300 350 400																	
80	250 280 300 350 400 450																		

Catalog No.	D	L Increments of 1 mm
SGRL	25	70~200
	32	80~250
SGRNL	38	80~300
	50	120~350
	60	140~400
	80	200~450



Order

Catalog No.	D	L
SGRN	32	170
SGRL	60	320



Option

See page 116~ for option details.

Option Code	Specification
C	Dowel pin hole for location is drilled at the center of the guide post.
M	Tapped hole for the height block is drilled on the guide holder. (D=25, 32 only)
W	Tapped hole for the height block is drilled on the guide bushing.
RH	Guide holder is changed to the inverted mounting type.
RB	Guide bushing is changed to the inverted mounting type.
RHB	Both guide bushing and holder are changed to the inverted mounting type.
HK	Guide holder height is machined to the tolerance of ±0.1.
BK	Guide bushing height is machined to the tolerance of ±0.1.
HBK	Both guide holder and bushing heights are machined to the tolerance of ±0.1.
BM	Tapped hole for lifting bolt is drilled on the guide bushing. (D=25~50only)
HM	Tapped hole for jack screw is drilled on the guide bushing. (D=25~50only)



Order

SGRN 32 - 170 - RHB