

Guide Post Set

PLAIN TYPE

CAD
FILE



SGO
SGOL (Type for Dimension L)
SGON
SGONL (Type for Dimension L)

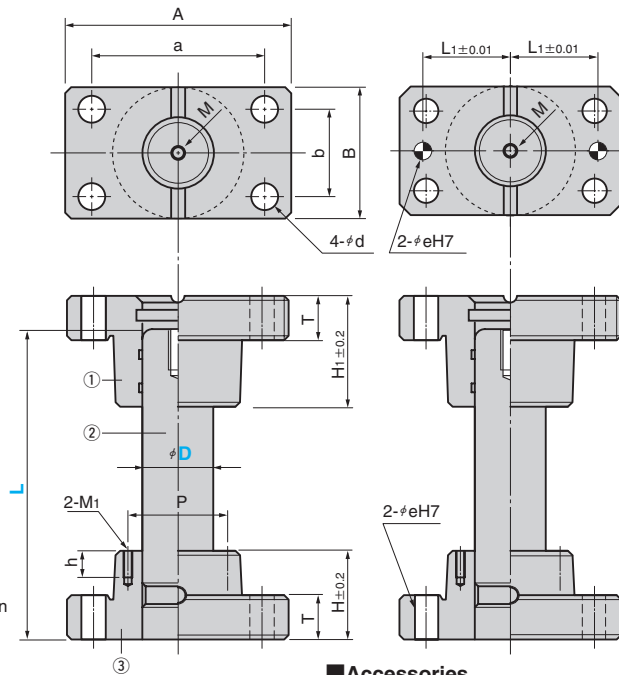

⚠ Tapped holes (2-M1) on Dia. φ38 and over.

Table of Components

No.	Description	Qty	Material and Remark	Catalog No.
①	Guide Bushing	1	FC250	SGB SGBN
②	Guide Post	1	S45C Induction hardening of HRC55 or more	NGP
③	Guide Holder	1	FC250	GPH GPHN
Accessories	Hexagon Socket Head Bolt	8	SCM435	
	Dowel Pin with Female Thread	4	SUJ2 Tolerance m6	

Accessories

D	Hexagon Socket Head Bolt	Dowel Pin
25	M 8×35	φ8×30
32	M10×40	
38	M10×45	φ10×40
50	M12×50	
60	M16×60	φ13×50
80	M20×75	φ16×60

D Tolerance	A	a	B	b	T	H	P	M1	h	H1	d	M	L1	e	H7
25	+0.024 +0.015	84	66	48	30	20	30	-	-	45	9	-	33	8	
32		100	76	58	36		40			50	11	-	38		+0.015 0
38	+0.028 +0.017	130	100	75	44	25	50	60	M5	15	60		50	10	
50		155	125	90	60		65	72	M6		85	14	62.5		
60	+0.033 +0.020	190	150	120	80	30	75	92	M8	20	100	18	75	13	+0.018 0
80		230	180	150	110	35	100	116			130	22	95	16	

Catalog No.	D	L																	
	25	80	90	100	110	120	130	140	150	160	170	180	200						
	32	90 100 110 120 130 140 150 160 170 180 200 220 250																	
SGO	38	100 110 120 130 140 150 160 170 180 200 220 250 280 300																	
SGON	50	160 170 180 200 220 250 280 300 350																	
	60	180 200 220 250 280 300 350 400																	
	80	250 280 300 350 400 450																	

Catalog No.	D	L
	25	70~200
	32	80~250
SGOL	38	80~300
SGONL	50	120~350
	60	140~400
	80	200~450



Order

Catalog No.	D	-	L
SGO	32	-	160
SGONL	50	-	255



Option

See page 116~ for option details.

Option Code	Specification
C	Dowel pin hole for location is drilled at the center of the guide post.
M	Tapped hole for the height block is drilled on the guide holder. (D=25, 32 only)
W	Tapped hole for the height block is drilled on the guide bushing.
RH	Guide holder is changed to the inverted mounting type.
RB	Guide bushing is changed to the inverted mounting type.
RHB	Both guide bushing and holder are changed to the inverted mounting type.
HK	Guide holder height is machined to the tolerance of ±0.1.
BK	Guide bushing height is machined to the tolerance of ±0.1.
HBK	Both guide holder and bushing heights are machined to the tolerance of ±0.1.
BM	Tapped hole for lifting bolt is drilled on the guide bushing. (D=25~50only)
HM	Tapped hole for jack screw is drilled on the guide bushing. (D=25~50only)



Order

SGO 38 - 160 - C - W